

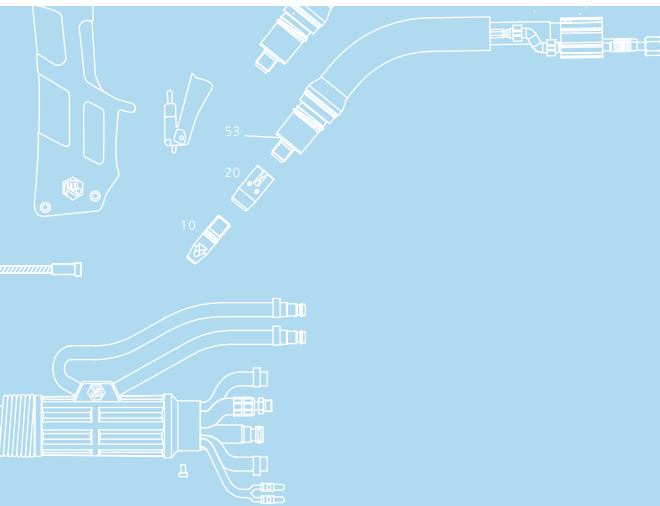

## Top 2000 TBI 9W (S, L, Alu)



### Ordering Information

TBi 9W-S	ESW, 50° bent	173P4425_0*
TBi 9W-L	ESW, 50° bent	173P5425_0*
TBi 9W Alu	ESW, 35° bent	173P5A25_0*

\* At the blank, please insert 3, 4 or 5 for a torch length of 3, 4 or 5 m.

2-circuit water cooling

Very suitable for pulse-arc welding

For aluminum-welding with high amperages

### Technical data

#### MIG/MAG (GMAW) Semi-automatic welding torch TBI 9W-S/9W-L/9W Alu

Rating at 100% duty cycle  
(10 min. cycle)

- Mixed gas:	500 A
- CO <sub>2</sub> :	550 A

Cooling method 2-circuit water cooling

Wire diameter 1.0 - 1.6

Gas flow 15 l/min

Technical specification according to IEC 60974-7

Weight with 1.5m cable 1.90 kg

Connection Euro-Central connector  
Other connectors (e.g. CLOOS®, ESAB®, Lincoln®) available upon request.

Torch rating will be reduced when using pulsed-arc power sources. Special torch necks and custom lengths of the cable assembly are available upon request.

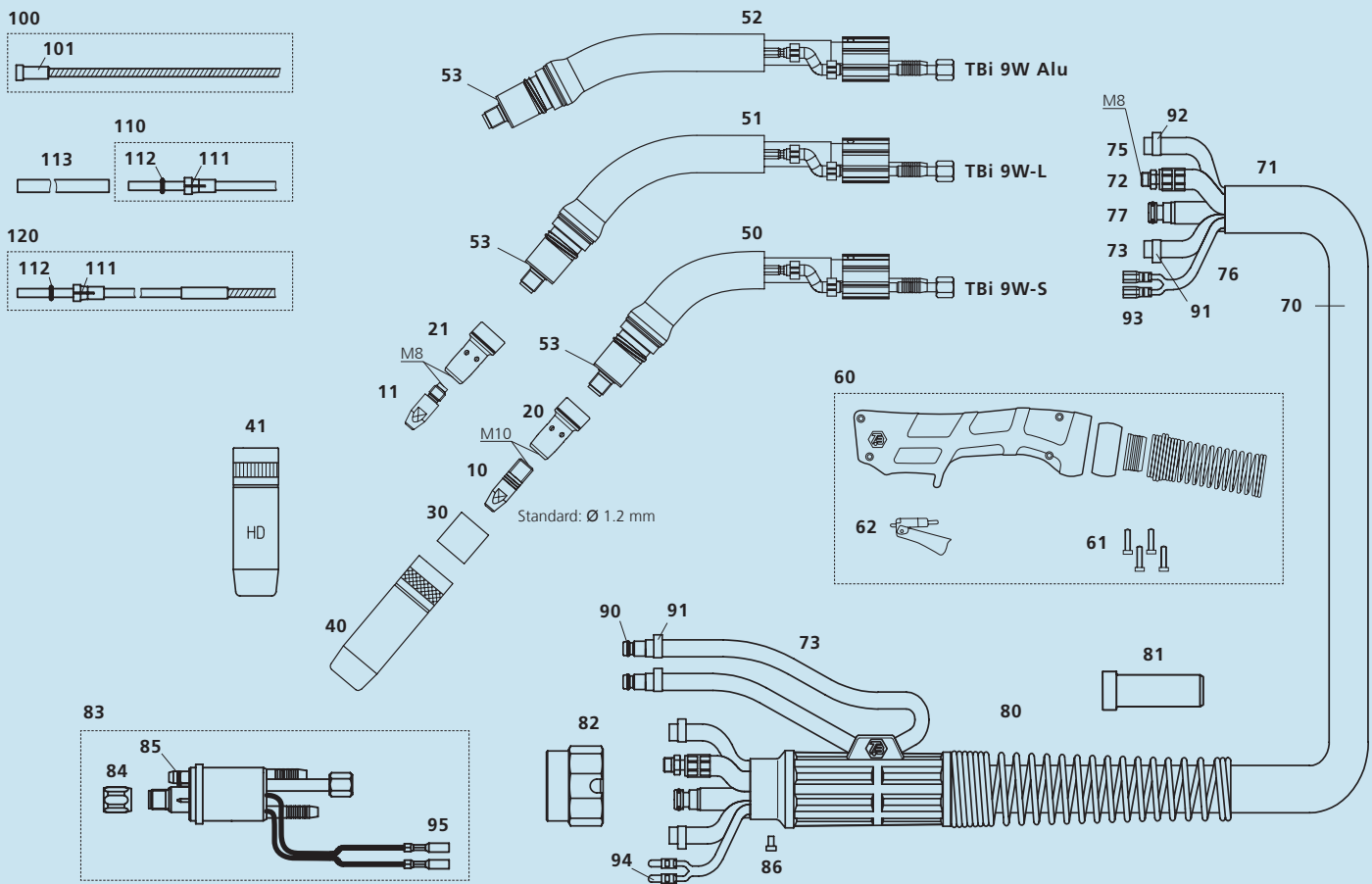

Pos. Description

Part. no.

Pos. Description

Part. no.

#### Contact tips

▶ 10	<b>Contact tip M10x33, Ecu</b>	<b>340P_1402*</b>
10	Contact tip M10x33, CuCrZr	343P_3402*
11	Contact tip M8x30, Ecu	340P_1262*
11	Contact tip M8x30, CuCrZr	340P_3262*
11	Contact tip M8x30 Alu, Ecu (Std. for Alu version)	341P_1262*

#### Tip holders

▶ 20	<b>Tip holder M10 / L=27 mm, CuCrZr</b>	<b>342P010071</b>
21	Tip holder M8 / L=30 mm, CuCrZr (Std. for Alu version)	342P008071

#### Gas diffusers / Nozzle insulators

▶ 30	<b>Nozzle insulator</b>	<b>346P054860</b>
------	-------------------------	-------------------

#### Gas nozzles

▶ 40	<b>Nozzle con., NW 16.00 mm, L=80.5 mm, chrome plated</b>	<b>345P022173</b>
41	Nozzle con. diam. 16.0mm L=80.5mm, HD	345P922271

#### Spare parts

50	Torch neck TBi 9W-S (short) , 50°	173P101002
51	Torch neck TBi 9W-L (long) , 50°	173P101001
52	Torch neck TBi 9W Alu, 35°	173P101003
53	Insulating sleeve	171P102021
60	Handle blue, cpl. kit (TBi 9W)	380P220402
61	Cross recessed screw M3.5x14	100P008413
62	Trigger, red, 2 poles	385P021016
70	Cable assembly TBi Top 2000, HD	171P4S45_0*
71	Fabric outer cover 25x1.5 mm, cpl.	307P2528_A*
72	Water-power cable Top 2000, black, HD	314P1622_0
73	Water hose 2-C, black, 5x1.5 mm	303P070000

75	PVC-Gas hose, black 4.5x1.5 mm	302P010000
76	Control cable x.30 m cpl.	301P2304_0*
77	Wire conduit yellow (Top 2000)	356P0C0C_0*
80	Cable support 3 parts cpl. with spring	701P101071
81	Cable support 70 sqmm	600P002107
82	Adaptor nut	701P001013
83	Central adaptor ESW cpl., moveable pins (Top 2000)	701P101006
84	Sleeve nut M10x1	701P002005
85	O-ring 4.0x1.0 mm (gas nipple)	365P100040
86	Slotted screw M4x6	100P008401
90	Quick connector	701P002064
91	Hose clamp Ø 9.5 with ring	373P100095
92	Hose clamp Ø 8.7	371P000087
93	Cable lug, flat	375P000023
94	Insulated connector, male, round	375P000004
95	Insulated connector, female, round	375P000003

#### Wire guides

▶ 100	<b>Liner w/o insulation (x.40 m) for wire 1.0-1.2</b>	<b>322P2045_4*</b>
100	Liner w/o insulation (x.40 m) for wire 1.4-1.6	322P2545_4*
101	Collet for liners dia. 4.5 mm	330P025045
110	Teflon liner red (x.50 m) for wire 1.0-1.2	326P2040_5*
110	Teflon liner yellow (x.50 m) for wire 1.2-1.6	326P2747_5*
111	Collet for teflon and PA liner 2.0x4.0 mm	331P020040
111	Collet for teflon and PA liner 2.7x4.7 mm	331P027047
112	O-ring 3.50x1.50 mm (teflon liner)	365P150035
113	Support tube 5x4.4 mm, L=150 mm	329P544150
120	PA-Alu wire guide (x.50 m) for wire 1.0-1.2	328P2040_A*
120	PA-Alu wire guide (x.50 m) for wire 1.2-1.6	328P2347_A*
120	PA-Alu wire guide (x.50 m) for wire 2.0-2.4	328P2947_A*

▶ = Standard equipment

\* At the blank, please insert suitable information for torch length or wire diameter, e.g. 08 for 0.8 mm or 3 for 3 m.

© 2009 TBI Industries GmbH. All rights reserved. Subject to change without notice. Warranty only when using original TBI consumables and spare parts. Excerpts and reprints not permitted. Nr. DOKP112192, 07/2009.

TBI Industries GmbH  
Ruhberg 14  
D-35463 Fernwald-Steinbach  
P.O. Box 67  
D-35461 Fernwald-Steinbach

Tel. + 49 6404 9171-0  
Fax. + 49 6404 9171-40  
Internet: [www.tbi-industries.com](http://www.tbi-industries.com)  
E-mail: [info@tbi-industries.com](mailto:info@tbi-industries.com)