



Classic TBi 252

Aircooled

Replaceable head insulator

TBi-Flex rubber coaxial cable

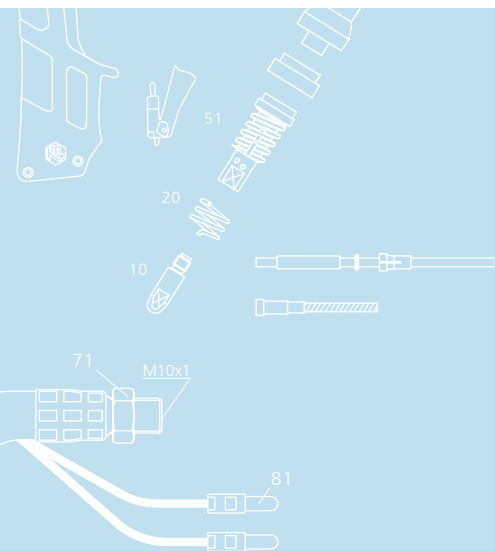

TBi 252, replaceable nozzle support and head insulator

Ordering Information

TBi 252 ESG, 50° bent 103P3413_0*

* At the blank, please insert 3, 4 or 5 for a torch length of 3, 4 or 5 m.

Technical data

MIG / MAG (GMAW) Semi-automatic welding torch TBi 252

Rating at 60% ED
(10 min. cycle)

- Mixed gas: 200 A
- CO₂: 230 A

Cooling method Aircooling

Wire diameter 0.8 - 1.2 mm

Gas flow 10 l/min

Technical specification according to IEC 60974-7

Weight with 1.5 m cable 1.20 kg

Connection Euro-Central connector.
Other connectors (e.g. Cloos®,
ESAB®) available upon request.

Torch rating will be reduced when using pulsed-arc power sources.
Special torch necks and custom lengths of the coaxial cable are
available upon request.

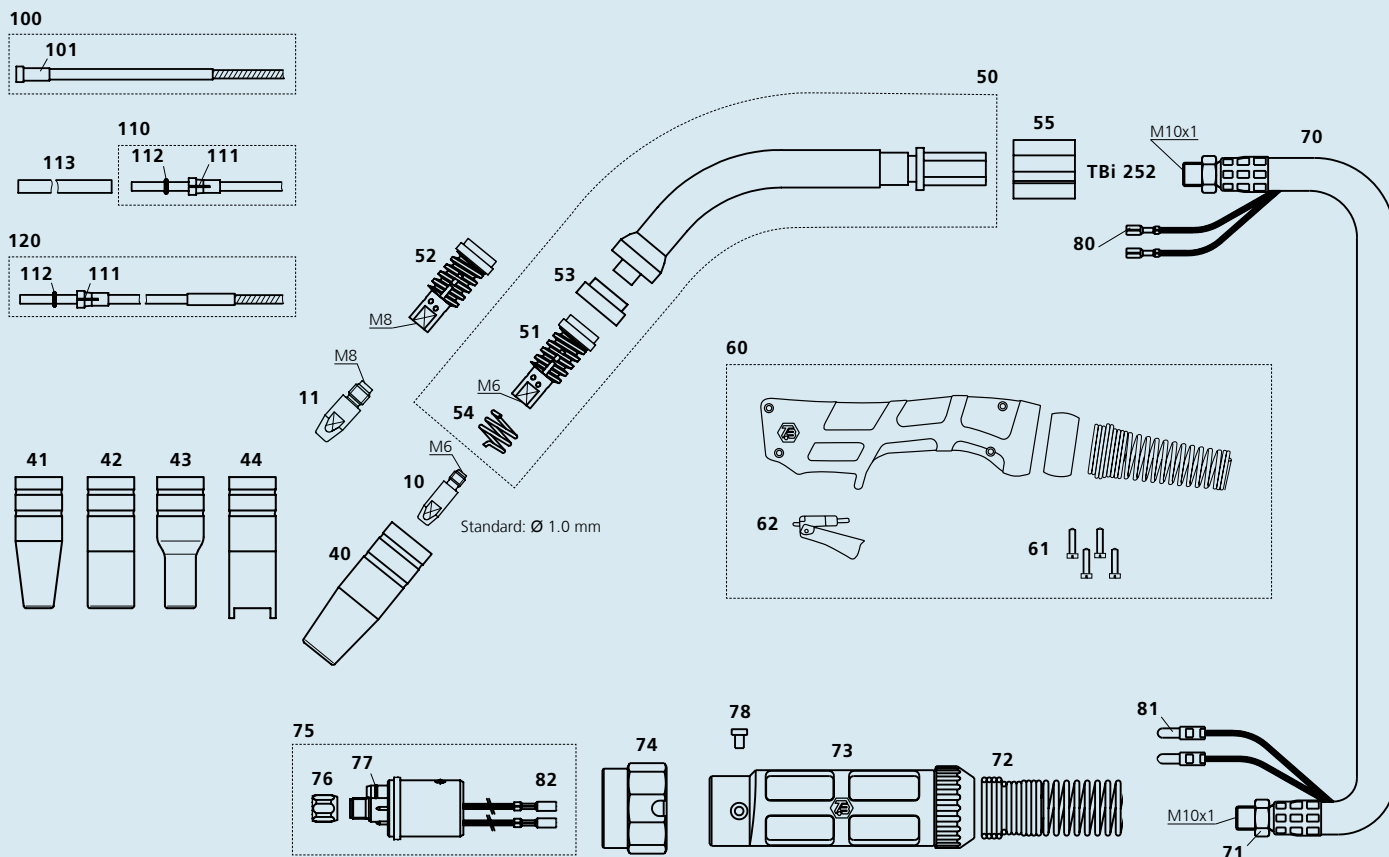

Pos. Description

Part. No.

Contact tips

▶ 10	Contact tip M6x28, Ecu	340P_1069*
10	Contact tip M6x28, CuCrZr	340P_3069*
10	Contact tip M6x28 Alu, Ecu	341P_1069*
11	Contact tip M8x30, Ecu	340P_1262*
11	Contact tip M8x30, CuCrZr	340P_3262*
11	Contact tip M8x30 Alu, Ecu	341P_1262*

Gas nozzles

▶ 40	Nozzle con. diam. 15.0 mm	345P012003
40	Nozzle con. diam. 15.0 mm long insul.	345P012303
41	Nozzle con. diam. 11.0 mm	345P013003
42	Nozzle cyl. diam. 20.0 mm	345P011003
42	Nozzle cyl. diam. 20.0 mm long insul.	345P011303
43	Nozzle bottle form diam. 14.0 mm	345P014003
43	Nozzle bottle form diam. 11.0 mm	345P014303
44	Spot weld nozzle diam. 18.0 mm long insul.	345P015503

Spare parts

50	Torch neck TBi 252 cpl., 50°	103P001001
51	Nozzle support TBi 252, M6	104P102003
52	Nozzle support TBi 252, M8	104P102005
53	Head insulator TBi 252	104P002003
54	Nozzle spring TBi 250/252/351	103P002006
55	PVC body	600P002017
60	Handle blue, aircooled, cpl. kit	380P220400
61	Cross recessed screw M 3.5x14	100P008413
62	Trigger, red, 2 poles	385P021016
70	TBi-Flex coaxial cable 25 sqmm	360P2511_0*
71	Hex nut M10x1	101P002005

Pos. Description

Part. No.

72	Spring support small 16-50 sqmm	600P102099
73	Cable support cpl. (2 pieces)	701P001045
74	PVC adaptor nut	701P002081
75	Central adaptor ESG cpl., 2 poles, moveable pins	701P001048
76	Sleeve nut M10x1	701P002005
77	O-ring 4.0x1.0 mm (gas nipple)	365P100040
78	Slotted screw M4x6	100P008401
80	Cable lug, flat	375P000023
81	Insulated connector, male, round	375P000004
82	Insulated connector, female, round	375P000003

Wire guides

100	Liner w/ insulation blue (x.40 m) for wire 0.8-1.0	324P1545_4*
▶ 100	Liner w/ insulation red (x.40 m) for wire 1.0-1.2	324P2045_4*
101	Collet for liners dia. 4.5 mm	330P025045
110	Teflon liner blue (x.50 m) for wire 0.6-0.9	326P1540_5*
110	Teflon liner red (x.50 m) for wire 1.0-1.2	326P2040_5*
111	Collet for teflon and PA liner 2.0x4.0 mm	331P020040
112	O-ring 3.50x1.50 mm (teflon liner)	365P150035
113	Support tube 5x4.4 mm, L=150 mm	329P544150
120	PA-Alu wire guide (x.50 m) for wire 1.0-1.2	328P2040_A*

▶ = Standard parts

* At the blank, please insert suitable information for torch length or wire diameter, e.g. 08 for 0.8 mm or 3 for 3 m.

© 2006 TBI Industries GmbH. All rights reserved. Subject to change without notice. Warranty only when using original TBI consumables and spare parts. Excerpts and reprints not permitted. Nr. DOKP111142, 03/2006.

TBI Industries GmbH
Ruhberg 14
D-35463 Fernwald-Steinbach
P.O. Box 67
D-35461 Fernwald-Steinbach

Tel. + 49 6404 9171-0
Fax. + 49 6404 9171-40
Internet: www.tbi-industries.com
E-mail: info@tbi-industries.com