



## Classic TBI 411 / 511

Water cooled

Robust and flexible water-power cable

### Technical data

#### MIG/MAG (GMAW) Semi-automatic welding torch TBI 411/511

Rating at 100% duty cycle  
(10 min. cycle)

- Mixed gas: 350 A (TBI 511: 450 A)  
- CO<sub>2</sub>: 400 A (TBI 511: 500 A)

Cooling method Water cooling

Wire diameter 1.0 - 1.2 mm (TBI 511: 1.0 - 1.6 mm)

Gas flow 14 l/min

Technical specification according to IEC 60974-7

Weight with 1.5 m cable 1.60 kg (TBI 511: 1.65 kg)

Connection Euro-Central connector  
Other connectors (e.g. CLOOS®, ESAB®, Lincoln®) available upon request.

Torch rating will be reduced when using pulsed-arc power sources. Special torch necks and custom lengths of the cable assembly are available upon request.

### Ordering Information

|         |               |             |
|---------|---------------|-------------|
| TBi 411 | ESW, 50° bent | 133P4415_0* |
| TBi 511 | ESW, 50° bent | 134P4415_0* |

\* At the blank, please insert 3, 4 or 5 for a torch length of 3, 4 or 5 m.

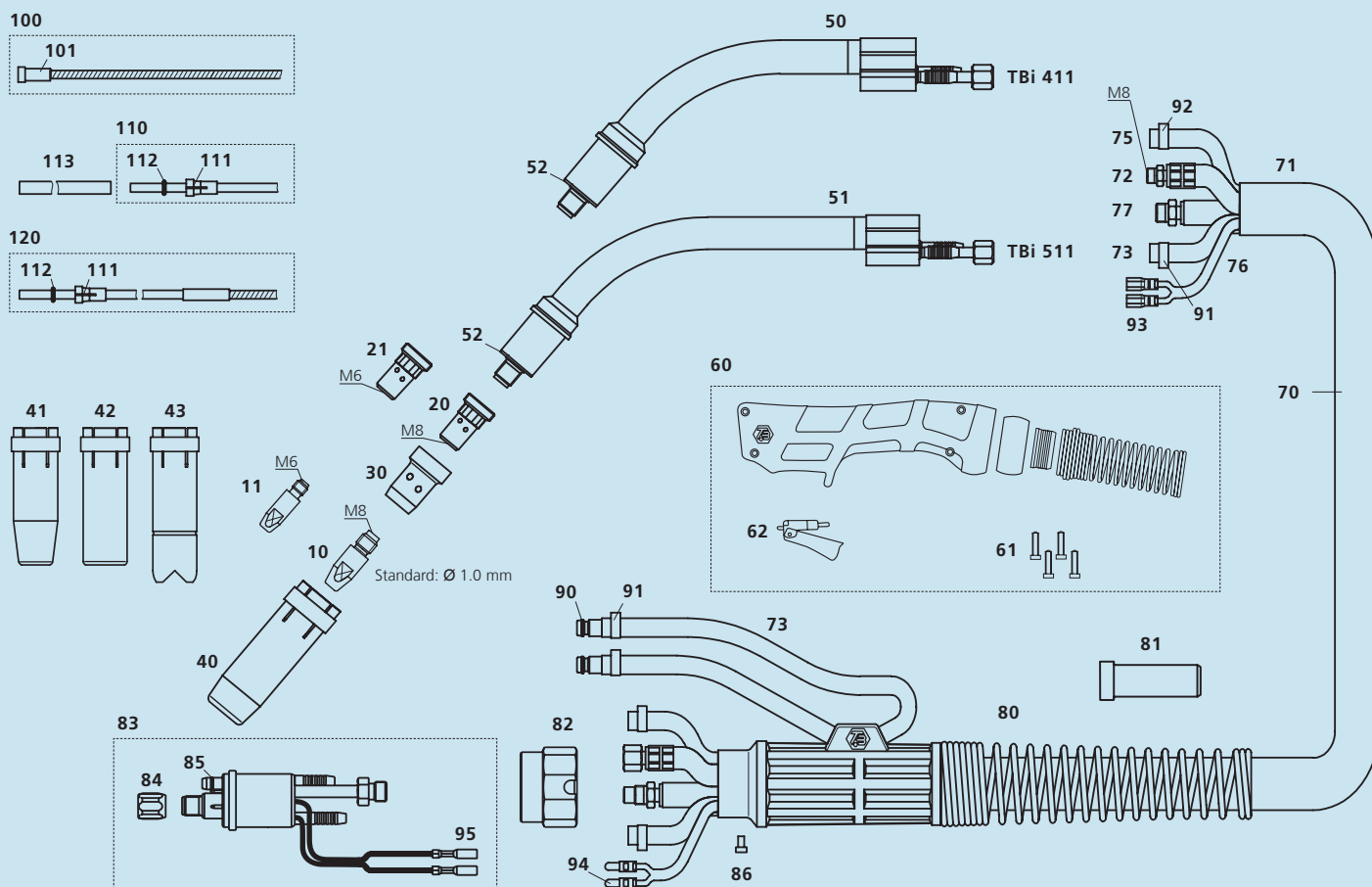

Pos. Description

#### Contact tips

| Pos. | Description                | Part no.   |
|------|----------------------------|------------|
| ▶ 10 | Contact tip M8x30, Ecu     | 340P_1262* |
| 10   | Contact tip M8x30, CuCrZr  | 340P_3262* |
| 10   | Contact tip M8x30 Alu, Ecu | 341P_1262* |
| 11   | Contact tip M6x28, Ecu     | 340P_1069* |
| 11   | Contact tip M6x28, CuCrZr  | 340P_3069* |
| 11   | Contact tip M6x28 Alu, Ecu | 341P_1069* |

#### Tip holders

| Pos. | Description             | Part no.   |
|------|-------------------------|------------|
| ▶ 20 | Tip holder M8 / L=25 mm | 342P008033 |
| 20   | Tip holder M8 / L=29 mm | 342P008133 |
| 21   | Tip holder M6 / L=25 mm | 342P006033 |
| 21   | Tip holder M6 / L=29 mm | 342P006133 |

#### Gas diffusers

| Pos. | Description           | Part no.   |
|------|-----------------------|------------|
| ▶ 30 | Gas diffuser, black   | 130P002026 |
| 30   | Gas diffuser, white   | 130P002017 |
| 30   | Gas diffuser, ceramic | 130P002019 |
| 30   | Gas diffuser, brown   | 130P002031 |

#### Gas nozzles

| Pos. | Description                    | Part no.   |
|------|--------------------------------|------------|
| ▶ 40 | Nozzle con. diam. 16.0 mm      | 345P012030 |
| 41   | Nozzle con. diam. 14.0 mm      | 345P013030 |
| 42   | Nozzle cyl. diam. 20.0 mm      | 345P011030 |
| 43   | Spot weld nozzle diam. 20.0 mm | 345P015030 |

#### Spare parts

|    |                                    |            |
|----|------------------------------------|------------|
| 50 | Torch neck Tbi 411, 50°            | 133P001001 |
| 51 | Torch neck Tbi 511, 50°            | 134P001001 |
| 52 | Insulating washer                  | 130P002004 |
| 60 | Handle blue, watercooled, cpl. kit | 380P220401 |
| 61 | Cross recessed screw M 3.5x14      | 100P008413 |

▶ = Standard parts

\* At the blank, please insert suitable information for torch length or wire diameter, e.g. 08 for 0.8 mm or 3 for 3 mm.

Pos. Description

|    |  |             |
|----|--|-------------|
| 62 | Trigger, red, 2 poles                            | 385P021016  |
| 70 | Cable assembly Classic, 2-C                      | 122P4045_0* |
| 71 | Fabric outer cover 25x1.5 mm, cpl.               | 307P2528_A* |
| 72 | Water-power cable Classic, blue, 2-C             | 316P1621_0* |
| 73 | PVC hose, braided, black, 5x1.5 mm               | 302P020000  |
| 75 | PVC-Gas hose, black 4.5x1.5 mm                   | 302P010000  |
| 76 | Control cable x.30 m cpl.                        | 301P2304_0* |
| 77 | Wire conduit yellow 'Classic'                    | 356P0401_0* |
| 80 | Cable support 3 parts cpl. with spring           | 701P101071  |
| 81 | Cable support 70 sqmm                            | 600P002107  |
| 82 | Adaptor nut                                      | 701P001013  |
| 83 | Central adaptor ESW cpl., 2 poles, moveable pins | 701P001049  |
| 84 | Sleeve nut M10x1                                 | 701P002005  |
| 85 | O-ring 4.0x1.0 mm (gas nipple)                   | 365P100040  |
| 86 | Slotted screw M4x6                               | 100P008401  |
| 90 | Quick connector                                  | 701P002064  |
| 91 | Hose clamp Ø 9.5 with ring                       | 373P100095  |
| 92 | Hose clamp Ø 8.7                                 | 371P000087  |
| 93 | Cable lug, flat                                  | 375P000023  |
| 94 | Insulated connector, male, round                 | 375P000004  |
| 95 | Insulated connector, female, round               | 375P000003  |

#### Wire guides

| Pos.  | Description                                    | Part no.    |
|-------|--|-------------|
| ▶ 100 | Liner w/o insulation (x.40 m) for wire 1.0-1.2 | 322P2045_4* |
| 100   | Liner w/o insulation (x.40 m) for wire 1.4-1.6 | 322P2545_4* |
| 101   | Collet for liners dia. 4.5 mm                  | 330P025045  |
| 110   | Teflon liner red (x.50 m) for wire 1.0-1.2     | 326P2040_5* |
| 110   | Teflon liner yellow (x.50 m) for wire 1.2-1.6  | 326P2747_5* |
| 111   | Collet for teflon and PA liner 2.0x4.0 mm      | 331P020040  |
| 111   | Collet for teflon and PA liner 2.7x4.7 mm      | 331P027047  |
| 112   | O-ring 3.50x1.50 mm (teflon liner)             | 365P150035  |
| 113   | Support tube 5x4.4 mm, L=150 mm                | 329P544150  |
| 120   | PA-Alu wire guide (x.50 m) for wire 1.0-1.2    | 328P2040_A* |
| 120   | PA-Alu wire guide (x.50 m) for wire 1.2-1.6    | 328P2347_A* |
| 120   | PA-Alu wire guide (x.50 m) for wire 2.0-2.4    | 328P2947_A* |