



Classic TBi 150 E1 DR

Air cooled

Changeable swivel neck

Screw-on fume shroud

Technical data

MIG/MAG semi-automatic fume extraction welding torch TBi 150 E1 DR

Rating at 60% duty cycle
(10 min. cycle)

- Mixed gas: 150 A
- CO₂: 180 A

Cooling method: air cooling

Wire diameter: 0.6 - 1.0 mm

Gas flow: 8 l/min

Technical specification: according to IEC 60974-7

Weight with 1.5m cable: 1.30 kg

Connection: Euro-Central connector,
other connectors (e.g. CLOOS®, ESAB®,
Lincoln®) available upon request.

Torch rating will be reduced when using pulsed-arc power sources.
Custom lengths of the cable assembly are available upon request.

Ordering Information

TBi 150 E1 DR ESG, 50° bent 252P901A_0*

* At the blank, please insert 3, 4 or 5 for a torch length of 3, 4 or 5m.

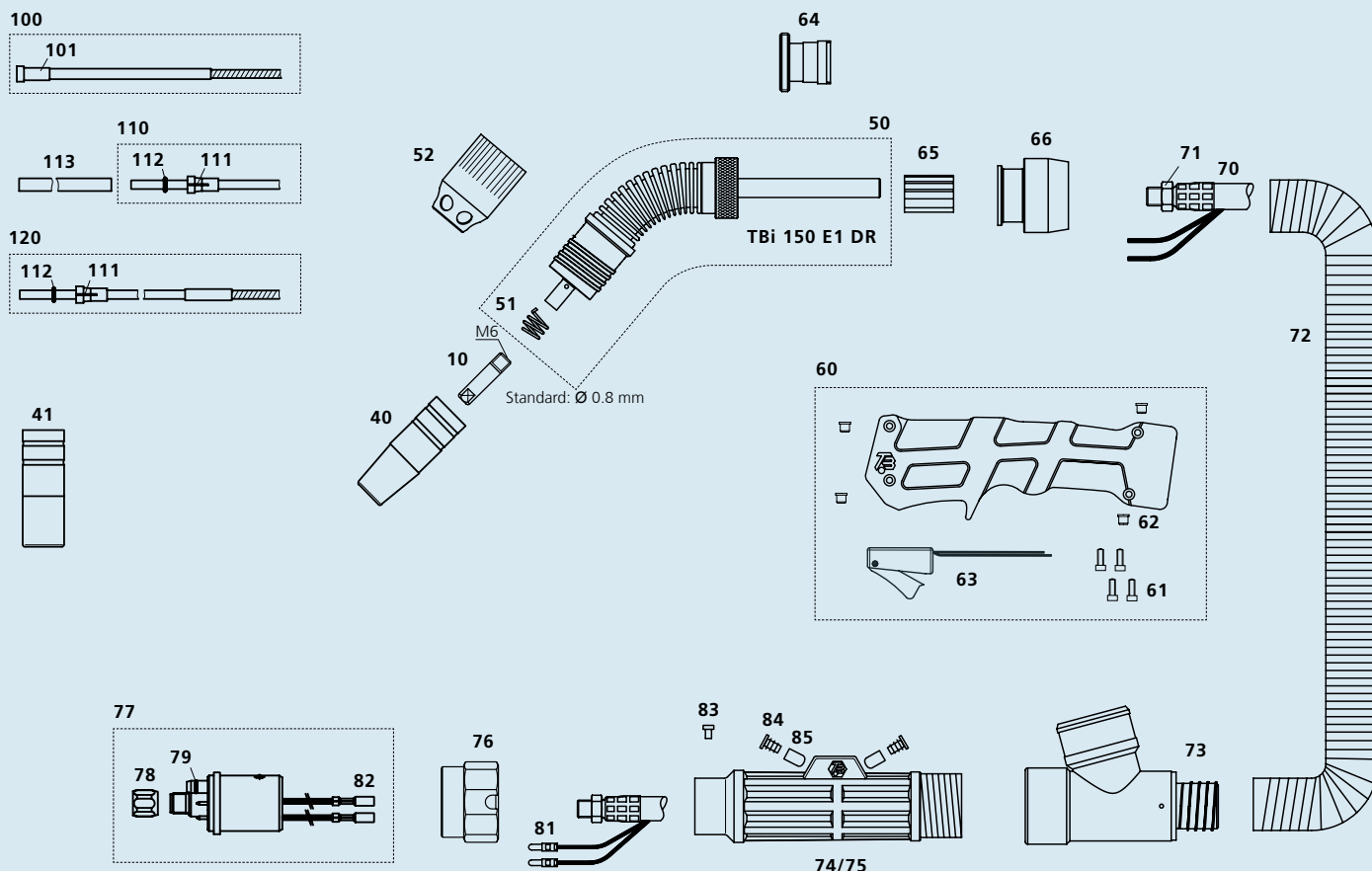

Pos. Description

Part. No.

Pos. Description

Part. No.

Contact tips

▶ 10	Contact tip M6x25, Ecu	340P_1073*
10	Contact tip M6x25, CuCrZr	340P_3073*
10	Contact tip M6x25 Alu, Ecu	341P_1073*

Gas nozzles

▶ 40	Nozzle con. diam. 12.0 mm	345P012002
40	Nozzle con. diam. 12.0 mm long insul.	345P012402
41	Nozzle cyl. diam. 16.0 mm	345P011002
41	Nozzle cyl. diam. 16.0 mm long insul.	345P011402

Spare parts

50	Torch neck TBI 150 E1 DR, cpl.	252P101021
51	Nozzle spring TBI 140/145/150	102P002011
52	Fume shroud TBI 150 E1	252P102006
60	Handle cpl., blue, housed micro switch, TBI E1	380P226001
61	Socket cap screw M4x10	109P091204
62	Threaded bush M4	252P102016
63	Micro switch, housed, cpl.	600P101046
-	Gasket for handle TBI E1	252P102015
64	Adaptor for torch neck TBI E1 DR	252P102022
65	Brass block TBI E1 DR	252P102019
66	Handle fitting for 29 mm fume hose	252P102026
70	Coaxial cable cpl., 25 sqmm	359P2511_0*
71	Hex nut M10x1	101P002005
72	Fume extraction hose D=29 mm	306P293600
73	T-joint cpl. for 29 mm fume hose	200P101013
74	Cable support housing (only with pos. 75)	701P102070
75	Cable support cover (only with pos. 74)	701P102071
76	Adaptor nut	701P001013

Wire guides

100	Liner w/ insulation white (x.40 m) for wire 0.6-0.9	324P1338_4*
▶ 100	Liner w/ insulation blue (x.40 m) for wire 0.8-1.0	324P1545_4*
101	Collet for liner 1.3x3.8 mm	330P015040
101	Collet for liners dia. 4.5 mm	330P025045
110	Teflon liner blue (x.50 m) for wire 0.6-0.9	326P1540_5*
111	Collet for teflon and PA liner 4.0 mm	331P020040
112	O-ring 3.50x1.50 mm (teflon liner)	365P150035
113	Support tube 5x4.4 mm, L=150 mm	329P544150
120	PA-Alu wire guide (x.50 m) for wire 1.0-1.2	328P2040_A*

▶ = Standard equipment

* At the blank, please insert suitable information for torch length or wire diameter, e.g. 08 for 0.8 mm or 3 for 3 m.

© 2007 TBI Industries GmbH. All rights reserved. Subject to change without notice. Warranty only when using original TBI consumables and spare parts. Excerpts and reprints not permitted. Nr. DOKP113112, 12/2007.

TBI Industries GmbH
Ruhberg 14
D-35463 Fernwald-Steinbach
P.O. Box 67
D-35461 Fernwald-Steinbach

Tel. + 49 6404 9171-0
Fax. + 49 6404 9171-40
Internet: www.tbi-industries.com
E-mail: info@tbi-industries.com