



Classic TBi 150 E3

Air cooled

Uses same consumables as TBi 150

Slip-on fume shroud

Technical data

MIG/MAG semi-automatic fume extraction welding torch TBi 150 E3

Rating at 60% duty cycle
(10 min. cycle)

- Mixed gas: 150 A
- CO₂: 180 A

Cooling method air cooling

Wire diameter 0.6 - 1.0 mm

Gas flow 8 l/min

Technical specification according to IEC 60974-7

Weight with 1.5m cable 1.20 kg

Connection Euro-Central connector,
other connectors (e.g. CLOOS®, ESAB®,
Lincoln®) available upon request.

Torch rating will be reduced when using pulsed-arc power sources.
Custom lengths of the cable assembly are available upon request.

Ordering Information

TBi 150 E3 ESG, 50° bent 202P3X13_0*

* At the blank, please insert 3, 4 or 5 for a torch length of 3, 4 or 5 m.

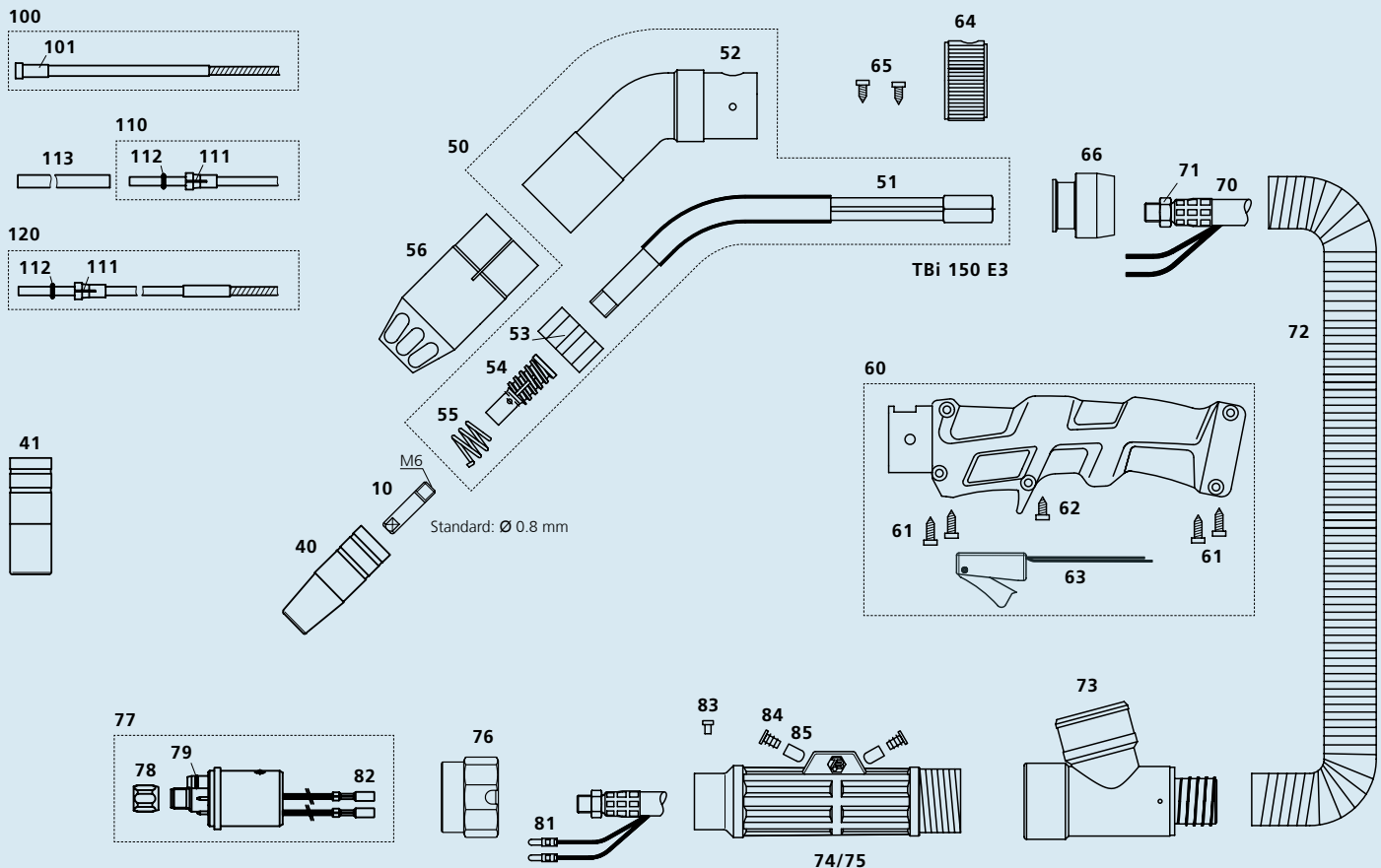

Pos. Description

Part. No.

Pos. Description

Part. No.

Contact tips

| | | |
|------|----------------------------|------------|
| ▶ 10 | Contact tip M6x25, Ecu | 340P_1073* |
| 10 | Contact tip M6x25, CuCrZr | 340P_3073* |
| 10 | Contact tip M6x25 Alu, Ecu | 341P_1073* |

Gas nozzles

| | | |
|------|---------------------------------------|------------|
| ▶ 40 | Nozzle con. diam. 12.0 mm | 345P012002 |
| 40 | Nozzle con. diam. 12.0 mm long insul. | 345P012402 |
| 41 | Nozzle cyl. diam. 16.0 mm | 345P011002 |
| 41 | Nozzle cyl. diam. 16.0 mm long insul. | 345P011402 |

Spare parts

| | | |
|----|---------------------------------------------------|-------------|
| 50 | Torch neck TBi 150 E3, cpl. | 202P001023 |
| 51 | Inner tube TBi 150 E3 | 202P001022 |
| 52 | Outer tube TBi 150 E3 | 202P001020 |
| 53 | Insulator TBi 150 E3 | 202P002007 |
| 54 | Nozzle support TBi 150 w/o spring | 102P002037 |
| 55 | Nozzle spring TBi 140/145/150 | 102P002011 |
| 56 | Fume shroud TBi 150 E3 | 202P002010 |
| 60 | Handle cpl., blue, housed micro switch, TBi E2/E3 | 380P220606 |
| 61 | Self-cutting screw 3.5x14.0 mm | 100P797101 |
| 62 | Self-cutting screw, short, TBi E3 | 100P008411 |
| 63 | Micro switch, housed, cpl. | 600P101046 |
| 64 | Air regulator small | 200P102003 |
| 65 | Screw for air regulator | 100P797103 |
| 66 | Handle fitting for 29 mm fume hose | 252P102026 |
| 70 | Coaxial cable cpl., 16 sqmm | 359P1611_0* |
| 71 | Hex nut M10x1 | 101P002005 |
| 72 | Fume extraction hose D=29 mm | 306P293600 |

| | | |
|----|--------------------------------------------------|------------|
| 73 | T-joint cpl. for 29 mm fume hose | 200P101013 |
| 74 | Cable support housing (only with pos. 75) | 701P102070 |
| 75 | Cable support cover (only with pos. 74) | 701P102071 |
| 76 | Adaptor nut | 701P001013 |
| 77 | Central adaptor ESG cpl., 2 poles, moveable pins | 701P001048 |
| 78 | Sleeve nut M10x1 | 701P002005 |
| 79 | O-ring 4.0x1.0 mm (gas nipple) | 365P100040 |
| 81 | Insulated connector, male, round | 375P000004 |
| 82 | Insulated connector, female, round | 375P000003 |
| 83 | Slotted screw M4x6 | 100P008401 |
| 84 | Square cap | 200P102006 |
| 85 | Cap for water connector | 395P000004 |

Wire guides

| | | |
|-------|-----------------------------------------------------|-------------|
| 100 | Liner w/ insulation white (x.40 m) for wire 0.6-0.9 | 324P1338_4* |
| ▶ 100 | Liner w/ insulation blue (x.40 m) for wire 0.8-1.0 | 324P1545_4* |
| 101 | Collet for liner 1.3x3.8 mm | 330P015040 |
| 101 | Collet for liners dia. 4.5 mm | 330P025045 |
| 110 | Teflon liner blue (x.50 m) for wire 0.6-0.9 | 326P1540_5* |
| 111 | Collet for teflon and PA liner 4.0 mm | 331P020040 |
| 112 | O-ring 3.50x1.50 mm (teflon liner) | 365P150035 |
| 113 | Support tube 5x4.4 mm, L=150 mm | 329P544150 |
| 120 | PA-Alu wire guide (x.50 m) for wire 1.0-1.2 | 328P2040_A* |

▶ = Standard equipment

* At the blank, please insert suitable information for torch length or wire diameter, e.g. 08 for 0.8 mm or 3 for 3 m.

© 2007 TBi Industries GmbH. All rights reserved. Subject to change without notice. Warranty only when using original TBi consumables and spare parts. Excerpts and reprints not permitted. Nr. DOKP113502, 12/2007.