

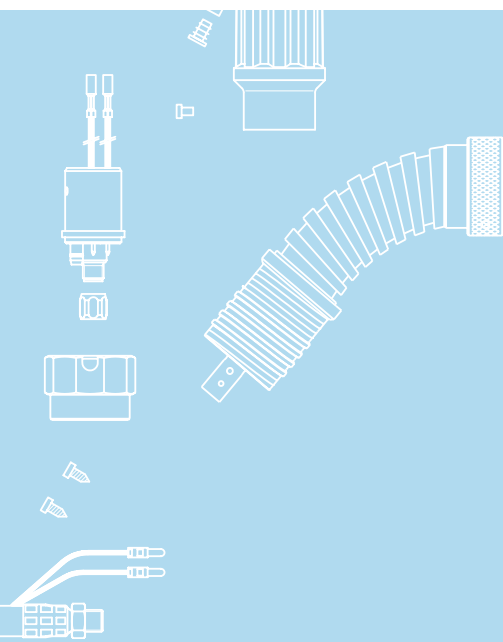

Classic TBi 511 E3



Water cooled

Same consumables as TBi 511

Slip-on fume shroud

Technical data

MIG/MAG semi-automatic fume extraction welding torch TBi 511 E3

Rating at 100% duty cycle
(10 min. cycle)

- Mixed gas: 450 A
- CO₂: 500 A

Cooling method water cooling

Wire diameter 1.0 - 1.6 mm

Gas flow 14 l/min

Technical specification according to IEC 60974-7

Weight with 1.5m cable 1.70 kg

Connection Euro-Central connector,
other connectors (e.g. CLOOS®, ESAB®,
Lincoln®) available upon request.

Torch rating will be reduced when using pulsed-arc power sources.
Custom lengths of the cable assembly are available upon request.

Ordering Information

TBi 511 E3 ESW, 50° bent 234P4X15_0*

* At the blank, please insert 3, 4 or 5 for a torch length of 3, 4 or 5m.

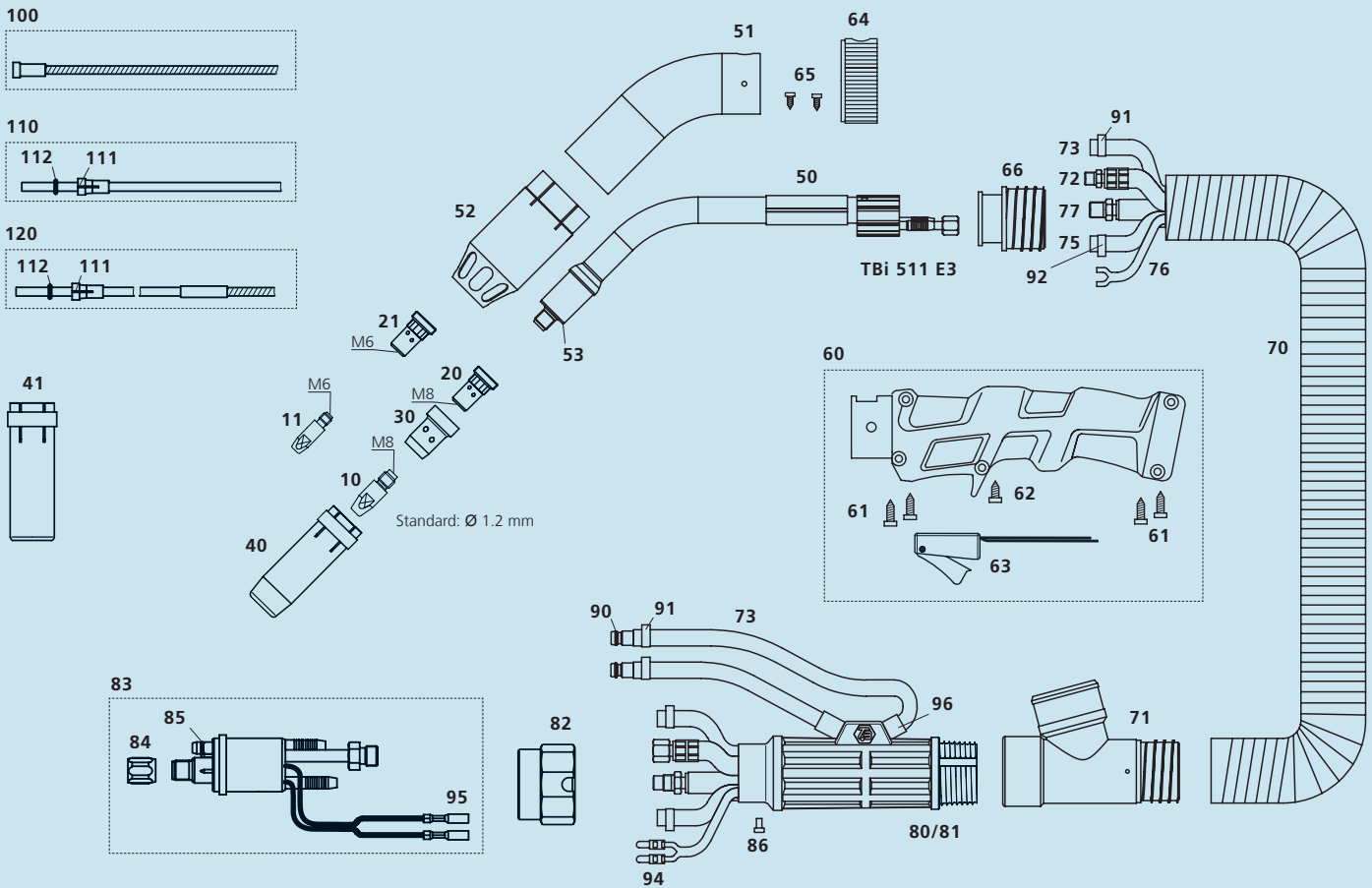

Pos.	Description	Part. No.	Pos.	Description	Part. No.
Contact tips					
▶ 10	Contact tip M8x30, Ecu	340P_1262*	63	Micro switch, housed, cpl.	600P101046
10	Contact tip M8x30, CuCrZr	340P_3262*	64	Air regulator large	200P102001
10	Contact tip M8x30 Alu, Ecu	341P_1262*	65	Fillister head screw, 2.9x6.5 mm	100P797103
11	Contact tip M6x28, Ecu	340P_1069*	66	Handle fitting for 38 mm fume hose	274P102011
11	Contact tip M6x28, CuCrZr	340P_3069*	70	Fume extraction hose D=38 mm	306P384600
11	Contact tip M6x28 Alu, Ecu	341P_1069*	71	T-joint cpl. for 38 mm fume hose	200P101012
Tip holders					
▶ 20	Tip holder M8 / L=25 mm	342P008033	72	Water-power cable Classic, blue, 2-C	316P1621_0*
20	Tip holder M8 / L=29 mm	342P008133	73	PVC hose, braided, black, 5x1.5 mm	302P020000
21	Tip holder M6 / L=25 mm	342P006033	75	PVC-Gas hose, black, 4.5x1.5 mm	302P010000
21	Tip holder M6 / L=29 mm	342P006133	76	Control cable x.10m, round, cpl., for Tbi E1/E2/E3	301P2304_1*
Gas diffusers					
▶ 30	Gas diffuser, black	130P002026	77	Wire conduit yellow 'Classic'	356P0401_0*
30	Gas diffuser, white	130P002017	80	Cable support housing (only with pos. 81)	701P102070
30	Gas diffuser, brown	130P002031	81	Cable support cover (only with pos. 80)	701P102071
Gas nozzles					
▶ 40	Nozzle con. diam. 16.0 mm	345P012030	82	Adaptor nut	701P001013
41	Nozzle cyl. diam. 20.0 mm	345P011030	83	Central adaptor ESW cpl., 2 poles, moveable pins	701P001049
Spare parts					
50	Torch neck Tbi 511 E3	234P001036	84	Sleeve nut M10x1	701P002005
51	Outer tube Tbi 360/511/7G/7W E3	234P102035	85	O-ring 4.0x1.0 mm (gas nipple)	365P100040
52	Fume shroud Tbi 360/511/7G/7W/8W E3	200P002043	86	Slotted screw M4x6	100P008401
53	Insulating washer	130P002004	90	Quick connector	701P002064
60	Handle cpl., blue, housed micro switch, Tbi E2/E3	380P220606	91	Hose clamp Ø 9.5 with ring	373P100095
61	Self-cutting screw 3.5x14.0 mm	100P797101	92	Hose clamp Ø 8.7	371P000087
62	Self-cutting screw, short, Tbi E3	100P008411	94	Insulated connector, male, round	375P000004
			95	Insulated connector, female, round	375P000003
			96	Rubber hose 10x2.0 mm	310P102102
Wire guides					
▶ 100	Liner w/o insulation (x.40 m) for wire 1.0-1.2	322P2045_4*			
100	Liner w/o insulation (x.40 m) for wire 1.4-1.6	322P2545_4*			
110	Teflon liner red (x.50 m) for wire 1.0-1.2	326P2040_5*			
110	Teflon liner yellow (x.50 m) for wire 1.2-1.6	326P2747_5*			
111	Collet for teflon and PA liner 4.0 mm	331P020040			
111	Collet for teflon and PA liner 4.7 mm	331P027047			
112	O-ring 3.50x1.50 mm (teflon liner)	365P150035			
120	PA-Alu wire guide (x.50 m) for wire 1.0-1.2	328P2040_A*			
120	PA-Alu wire guide (x.50 m) for wire 1.2-1.6	328P2347_A*			

▶ = Standard equipment

* At the blank, please insert suitable information for torch length or wire diameter, e.g. 08 for 0.8 mm or 3 for 3 m.

© 2009 Tbi Industries GmbH. All rights reserved. Subject to change without notice. Warranty only when using original Tbi consumables and spare parts. Excerpts and reprints not permitted. Nr. DOKP113552, 07/2009.