



Top 2000 TBi 8W E3

Water cooled

Same consumables as TBi 8G / TBi 8W

Slip-on fume shroud

Technical data

MIG/MAG semi-automatic fume extraction welding torch TBi 8W E3

Rating at 100% duty cycle

(10 min. cycle)

- Mixed gas: 500 A

- CO₂: 550 A

Cooling method water cooling

Wire diameter 1.2 - 3.2 mm

Gas flow 28 l/min

Technical specification according to IEC 60974-7

Weight with 1.5m Kabel 1.80 kg

Connection Euro-Central connector, other connectors (e.g. CLOOS®, ESAB®, Lincoln®) available upon request.

Torch rating will be reduced when using pulsed-arc power sources. Custom lengths of the cable assembly are available upon request.

Ordering information

TBi 8W E3 RWZ, 40° bent 272P4X25_0*

* At the blank, please insert 3, 4 or 5 for a torch length of 3, 4 or 5 m.

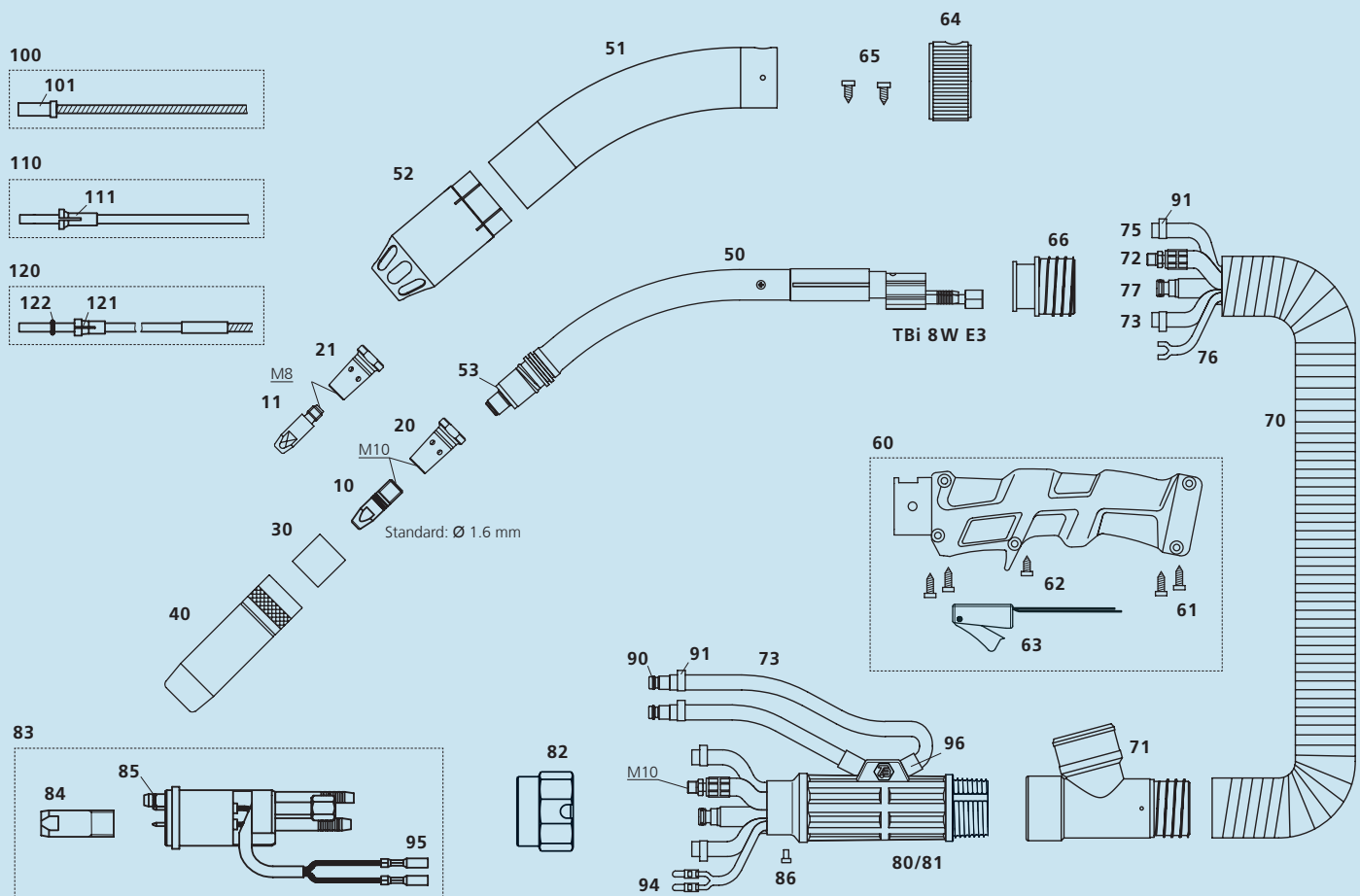

Pos.	Description	Part. No.	Pos.	Description	Part. No.
Contact tips					
▶ 10	Contact tip M10x33, ECu	340P_1402*	72	Water-power cable, blue, 2-C (TBi 8W E3)	316P16WW_0*
10	Contact tip M10x33, CuCrZr	343P_3402*	73	Water hose 2-C, black, 5x1.5 mm	303P070000
11	Contact tip M8x30, ECu	340P_1262*	75	PVC hose, braided, black, 5x1.5 mm	302P020000
11	Contact tip M8x30, CuCrZr	340P_3262*	76	Control cable x.10m, round, cpl., for Tbi E1/E2/E3	301P2304_1*
11	Contact tip M8x30 Alu, ECu	341P_1262*	77	Wire conduit, black (8W, 10W)	354P0C0C_0*
Tip holders					
▶ 20	Tip holder M10 / L=29 mm	342P010072	80	Cable support housing (only with pos. 81)	701P102070
21	Tip holder M8 / L=30 mm	342P008072	81	Cable support cover (only with pos. 80)	701P102071
Nozzle insulators					
▶ 30	Nozzle insulator glasfiber	346P054860	82	Adaptor nut	701P001013
Gas nozzles					
▶ 40	Nozzle con. diam. 16.0mm L=80.5mm	345P922171	83	Central adaptor RWZ cpl. (8W, 10W), moveable pins	701P001001
Spare parts					
50	Torch neck Tbi 8W E3	272P101050	84	Centering bolt M14x1 RGZ / RWZ	701P002083
51	Outer tube Tbi 8W E3	272P102053	85	O-ring 4.0x1.0 mm (gas nipple)	365P100040
52	Fume shroud Tbi 360/511/7G/7W/8W E3	200P002043	86	Slotted screw M4x6	100P008401
53	Insulating washer	172P102012	90	Quick connector	701P002064
60	Handle cpl., blue, housed micro switch, Tbi E2/E3	380P220606	91	Hose clamp Ø 9.5 with ring	373P100095
61	Self-cutting screw 3.5x14.0 mm	100P797101	94	Insulated connector, male, round	375P000004
62	Self-cutting screw, short, Tbi E3	100P008411	95	Insulated connector, female, round	375P000003
63	Micro switch, housed, cpl.	600P101046	96	Rubber hose 10x2.0 mm	310P102102
64	Air regulator large	200P102001	Wire guides		
65	Fillister head screw, 2.9x6.5 mm	100P797103	100	Liner w/o insulation (x.40 m) for wire 1.6-2.0	322P2863_4*
66	Handle fitting for 38 mm fume hose	274P102011	▶ 100	Liner w/o insulation (x.40 m) for wire 2.0-2.4	322P3570_4*
70	Fume extraction hose D=38 mm	306P384600	100	Liner w/o insulation (x.40 m) for wire 2.8-3.2	322P4570_4*
71	T-joint cpl. for 38 mm fume hose	200P101012	101	Collet for liner 2.8x6.3	330P028063
			101	Collet for liner 3.5x7.0	330P035070
			101	Collet for liner 4.5x7.0	330P045070
			110	Teflon liner white (x.50 m) for wire 1.6-2.8	326P4060_5*
			111	Collet for teflon and PA liners 4.0x6.0	331P040060
			120	PA-Alu wire guide (x.50 m) for wire 1.2-1.6	328P2347_A*
			120	PA-Alu wire guide (x.50 m) for wire 2.0-2.4	328P2947_A*
			121	Collet for teflon and PA liner 4.7 mm	331P027047
			122	O-ring 3.50x1.50 mm (teflon liner)	365P150035

▶ = Standard equipment

* At the blank, please insert suitable information for torch length or wire diameter, e.g. 08 for 0.8 mm or 3 for 3 m.

© 2009 Tbi Industries GmbH. All rights reserved. Subject to change without notice. Warranty only when using original Tbi consumables and spare parts. Excerpts and reprints not permitted. Nr. DOKP113442, 07/2009.

Tbi Industries GmbH
 Ruhberg 14
 D-35463 Fernwald-Steinbach
 P.O. Box 67
 D-35461 Fernwald-Steinbach

Tel. + 49 6404 9171-0
 Fax. + 49 6404 9171-40
 Internet: www.tbi-industries.com
 E-mail: info@tbi-industries.com