

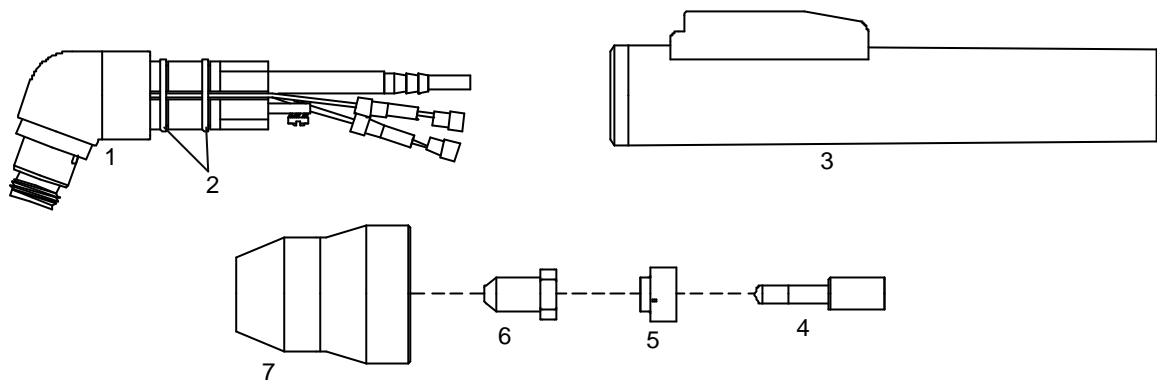

## PCH-10 Drag-Gun, Cougar 125



Pos.	Part no.	Ref. no.	Description	PU
N/S	441P884A16	2-1020	Hand torch PCH 10 complete with 20' ( 6 mts ) cable	1
1	441P884590	9-0016	70° Hand torch head	1
2	365P884001	8-0533	O-Ring	20
3	380P200398	9-0019E	Handgrip complete with microswitch	1
4	441P884660	9-6006	Electrode - Hf	10
5	441P884662	9-6007	Gas Distributor	10
6	441P884591	9-6099	Tip - Air	10
7	441P884666	9-6003	Shield Cup	10

CIRCLE CUTTING ATTACHMENT: See page no. 17

## PCH-25 Econopak 25, Pak Master 25

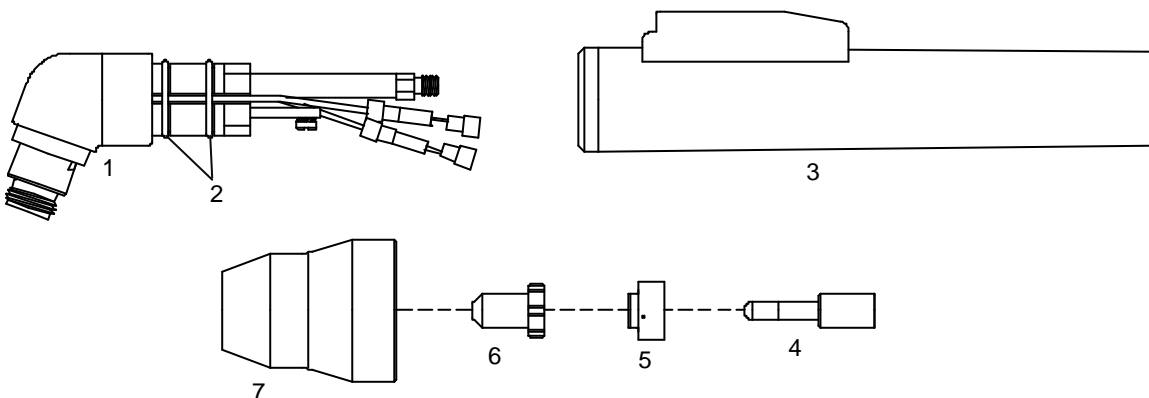

Pos.	Part no.	Ref. no.	Description	PU
N/S	441P884A24	2-0250	Hand torch PCH 25 complete with 12.5' ( 3.8 mts ) cable	1
N/S	441P884A28	2-0251	Hand torch PCH 25 complete with 25' ( 7.5 mts ) cable	1
1	441P884680	9-5807	70° Hand torch head	1
2	365P884001	8-0533	O-Ring	20
3	380P200398	9-6282E	Handgrip complete with microswitch	1
4	441P884660	9-6006	Electrode - Hf	10
5	441P884662	9-6007	Gas Distributor	10
6	441P884675	9-4476	Tip - Air	10
7	441P884666	9-6003	Shield Cup	10
N/S	316P460674	4-6067	Air and power cable 12.5' ( 3.8 mts ) - Hand torch	1
N/S	316P460688	4-6068	Air and power cable 25' ( 7.5 mts ) - Hand torch	1

CIRCLE CUTTING ATTACHMENT: See page no. 17