

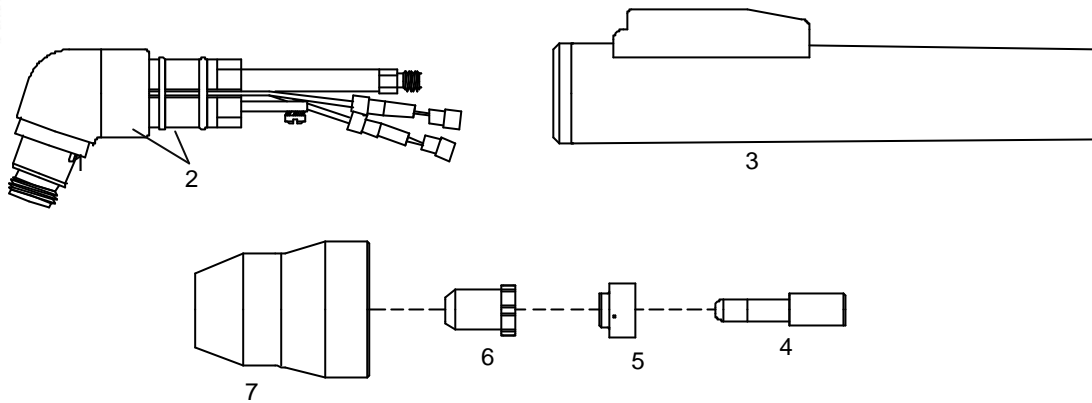

PCH-25/38 Pak Master 38XL, Drag-Gun 38



Pos.	Part no.	Ref. no.	Description	PU
N/S	441P884A24	2-0380	Hand torch PCH 25/38 complete with 12,5' (3.8 mts)	1
N/S	441P884A28	2-0381	Hand torch PCH 25/38 complete with 25' (7.5 mts)	1
1	441P884680	9-5807	70° Hand torch head	1
2	365P884001	8-0533	O-Ring	20
3	380P200398	9-6282E	Handgrip complete with microswitch	1
4	441P884669	9-6506	Electrode - Hf	10
5	441P884676	9-6507	Gas Distributor	10
6	441P884678	9-6501	Tip - Air	10
7	441P884666	9-6003	Shield Cup	10
N/S	316P460674	4-6067	Air and power cable 12.5' (3.8 mts) - Hand torch	1
N/S	316P460688	4-6068	Air and power cable 25' (7.5 mts) - Hand torch	1

CIRCLE CUTTING ATTACHMENT: See page no. 17

PCH-26 Econopak 50

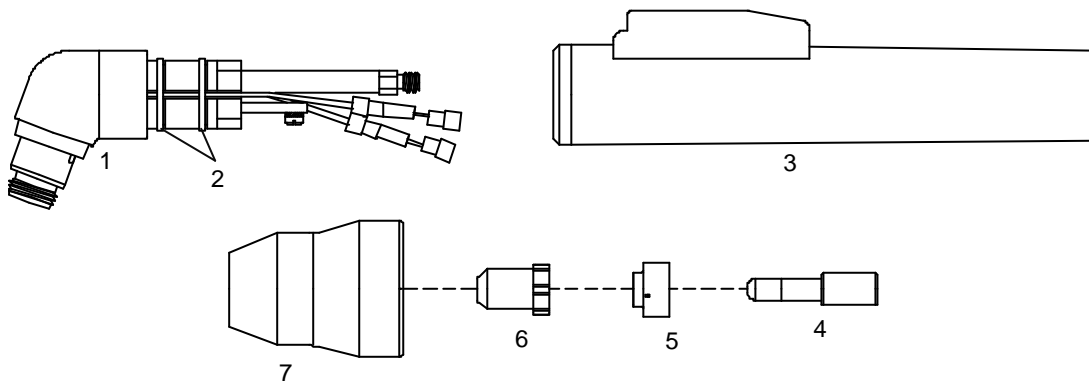

Pos.	Part no.	Ref. no.	Description	PU
N/S	441P884B14	2-3501	Hand torch PCH 26 complete with 12,5' (3.8 mts)	1
N/S	441P884B18	2-3511	Hand torch PCH 26 complete with 25' (7.5 mts)	1
1	441P884680	9-5807	70° Hand torch head	1
2	365P884001	8-0533	O-Ring	20
3	380P200398	9-6282E	Handgrip complete with microswitch	1
4	441P884669	9-6506	Electrode - Hf	10
5	441P884676	9-6507	Gas Distributor	10
6	441P884678	9-6501	Tip - Air	10
7	441P884666	9-6003	Shield Cup	10
N/S	316P460714	4-6071	Air and power cable 12.5' (3.8 mts) - Hand torch	1
N/S	316P460728	4-6072	Air and power cable 25' (7.5 mts) - Hand torch	1

CIRCLE CUTTING ATTACHMENT: See page no. 17