

# PLASMA CB 70

PLASMA RANGE



*trafimet*<sup>®</sup>



IEC 60974-7

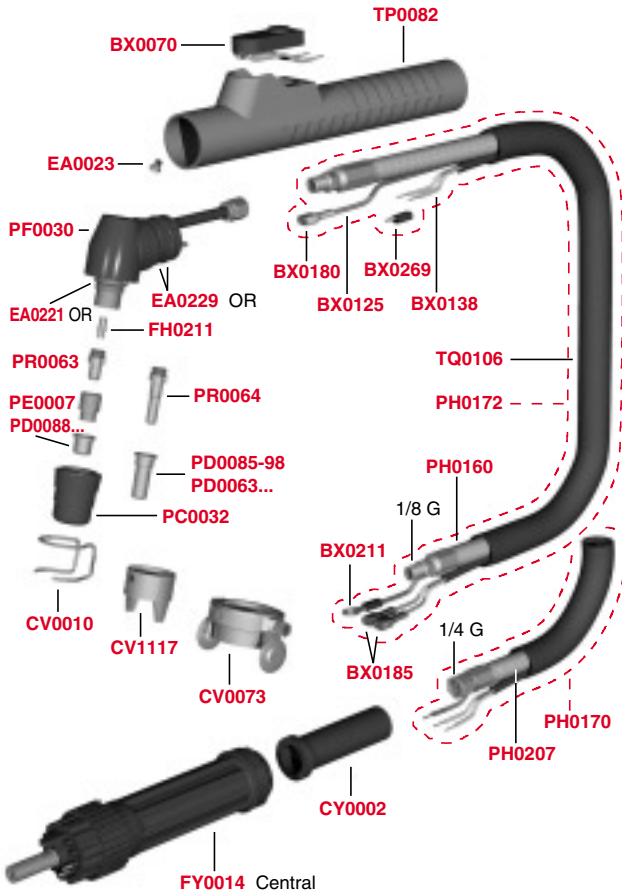

Pt. No.	Description	Pack	Euro	D
BX0070	Microswitch	10	9,50	B
BX0125	Cable for pilot arc per meter		0,80	B
BX0138	Control cable per meter		6,50	B
BX0180	Female faston	10	0,50	B
BX0185	Female faston	10	0,60	B
BX0211	Nipple	50	0,30	B
BX0269	Flat contact tip	10	0,40	B
CV0010	Stand off guide (743.0149/1394)	10	0,90	A
CV0073	Carriage	1	21,00	A
CV0074	Circle cutting attachment	1	51,00	A
CV0086	Flowmeter S 74 / CB 70	1	4,50	A
CV1117	Two pins crown shield (1405)	2	6,00	B
CY0002	Cable Support	1	1,10	B
EA0023	Screw	50	0,05	B
EA0221	O-ring	10	0,55	A
EA0229	O-ring	10	0,35	A
FH0211	Diffuser (3065204)	1	2,50	B
FY0014	Male central adaptor 7 pins	1	31,00	A
PC0032	Outside nozzle (57110171)	2	6,00	A
PD0063-10	Long tip Ø 1,0 long life	10	1,20	A
PD0063-11	Long tip Ø 1,1 long life	10	1,20	A
PD0063-12	Long tip Ø 1,2 long life	10	1,20	A
PD0085-98	Tip (1366)	10	1,20	A
PD0088-10	Tip Ø 1,0 long life	10	0,85	A
PD0088-11	Tip Ø 1,1 long life	10	0,85	A
PD0088-12	Tip Ø 1,2 long life	10	0,85	A
PE0007	Air diffuser	2	7,50	A
PF0030	Torch head (1351)	1	78,00	A
PH0160	Air-power cable 6m 1/8G	1	47,00	B
PH0170	Cable assembly 6m central adaptor	1	100,00	B
PH0172	Cable assembly 6m	1	80,00	B
PH0207	Air-power cable 6m 1/4G A 81	1	37,00	B
PR0063	Electrode - Hf. (1402)	10	1,20	A
PR0064	Long electrode (1403)	10	1,60	A
TP0082	Handle red Ø 28,5	1	18,00	B
TQ0106	Outer cover 20x22 per m		1,60	B

## COMPLETE TORCH

Pt. No.	Description	Pack	Euro	D
PA1270	Plasma CB 70 torch 6m	1	200,00	B
PA1272	Plasma CB 70 torch 6m central adaptor	1	230,00	B

## TECHNICAL DATA

**Voltage class** M

**Standard lenght m** 6

**Air consumption** 170 l/min

**Air pressure** 5 bar

**Duty cycle 60%** 70 A

**Duty cycle 100%** 50 A

