



PLASMA CB 100

PLASMA RANGE

trafimet®



IEC 60974-7



Pt. No.	Description	Pack	Euro	D
BX0070	Microswitch	10	9,50	B
BX0125	Cable for pilot arc per meter		0,80	B
BX0138	Control cable per meter		6,50	B
BX0185	Female faston	10	0,60	B
BX0207	Nipple	50	0,20	B
BX0211	Nipple	50	0,30	B
BX0269	Flat contact tip	10	0,40	B
CV0008	Contact cutting attachment	10	7,50	A
CV0009	Long contact cutting attachment	10	10,00	A
CV0011	Stand off guide (1386)	10	0,95	A
CV0012	Two pins crown shield	2	7,00	A
CV0021	Carriage	1	22,50	A
CV0022	Circle cutting attachment	1	58,00	A
CV0038	Contact cutting attachment	10	8,00	A
CV0088	Flowmeter per A 101 / P 101	1	4,50	A
CY0035	Cable Support	10	1,10	B
CY0036	Cable Support	10	0,80	B
EA0023	Screw	50	0,05	B
EA0131	O-ring	10	0,50	A
EA0132	O-ring	10	0,55	A
FH0214	Air cable	1	1,90	B
FY0023	Male central adaptor	1	26,00	A
PC0037	Outside nozzle CB 100	2	20,00	A
PC0038	Contact cutting nozzle long life	2	28,00	A
PD0025-14	Long Tip Ø 1,4 CB 100 / 150	10	3,70	A
PD0025-16	Long Tip Ø 1,6 CB 100 / 150	10	3,70	A
PD0025-18	Long Tip Ø 1,8 CB 100 / 150	10	3,70	A
PD0026-11	Tip Ø 1,1 (1371)	10	1,30	A
PD0026-13	Tip Ø 1,3 (1372)	10	1,30	A
PD0026-16	Tip Ø 1,6 (1373)	10	1,30	A
PD0026-18	Tip Ø 1,8 (1374)	10	1,30	A
PD0028-13	Contact cutting tip Ø 1,35	10	1,50	A
PD0028-16	Contact cutting tip Ø 1,6	10	1,50	A
PD0028-18	Contact cutting tip Ø 1,8	10	1,50	A
PD0030-11	Long Tip (1369)	10	4,00	A
PE0009	Air diffuser (1377)	2	8,30	A
PF0038	Torch head CB 100	1	140,00	A
PH0107	Air-power cable 6m 1/4G	1	50,00	B
PH0162	Air-power cable 6m 1/8G	1	50,00	B
PH0171	Cable assembly 6m	1	105,00	B
PH0174	Cable assembly 6m	1	105,00	B
PR0034	Electrode - Hf. (1376)	10	1,60	A
PR0045	Long electrode - Hf. (1517)	10	3,40	A
QB0164	Outer protection liner A 140 per meter		4,20	B
TP0083	Handle red Ø 24,5	1	18,00	B

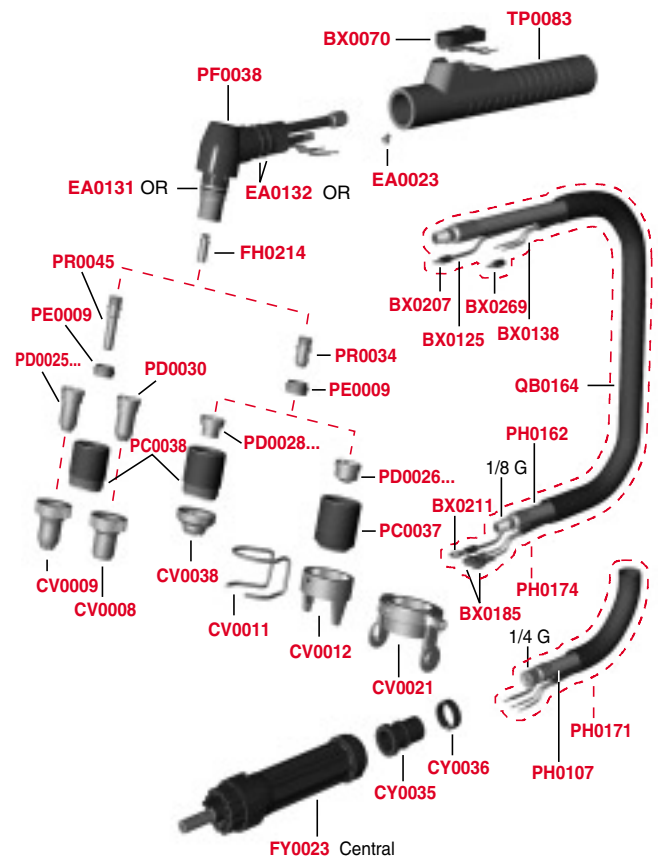

COMPLETE TORCH

Pt. No.	Description	Pack	Euro	D
PA1230	Plasma CB 100 torch 6m 1/8G	1	275,00	B
PA1232	Plasma CB 100 torch 6m central adaptor	1	305,00	B

TECHNICAL DATA

Voltage class	M
Standard length m	6
Air consumption	180 l/min
Air pressure	5 bar
Duty cycle 60%	100 A
Duty cycle 100%	70 A

