



PLASMA CB 50 P

P L A S M A R A N G E

trafiMet



IEC 60974-7

Pt. No.	Description	Pack	Euro	D
CY0002	Cable Support	1	1,10	B
EA0212	O-ring	10	0,55	A
EA0229	O-ring	10	0,35	A
FY0014	Male central adaptor 7 pins	1	31,00	A
PC0003	Outside nozzle (5710121)	4	6,00	A
PD0015	Tip (020115 - 1304)	10	0,80	A
PD0088-10	Tip Ø 1,0 long life	10	0,85	A
PD0088-11	Tip Ø 1,1 long life	10	0,85	A
PD0088-12	Tip Ø 1,2 long life	10	0,85	A
PE0007	Air diffuser	2	7,50	A
PF0035	Torch head	1	93,00	A
PH0170	Cable assembly 6m central adaptor	1	100,00	B
PH0217	Outer cover 6m steel	1	155,00	C
PR0016	Electrode - Zr. (1521-Z)	10	0,95	A
PR0017	Electrode - Hf. (020103 / 1521-H)	10	1,05	A
TP0061	Handle	1	75,00	B

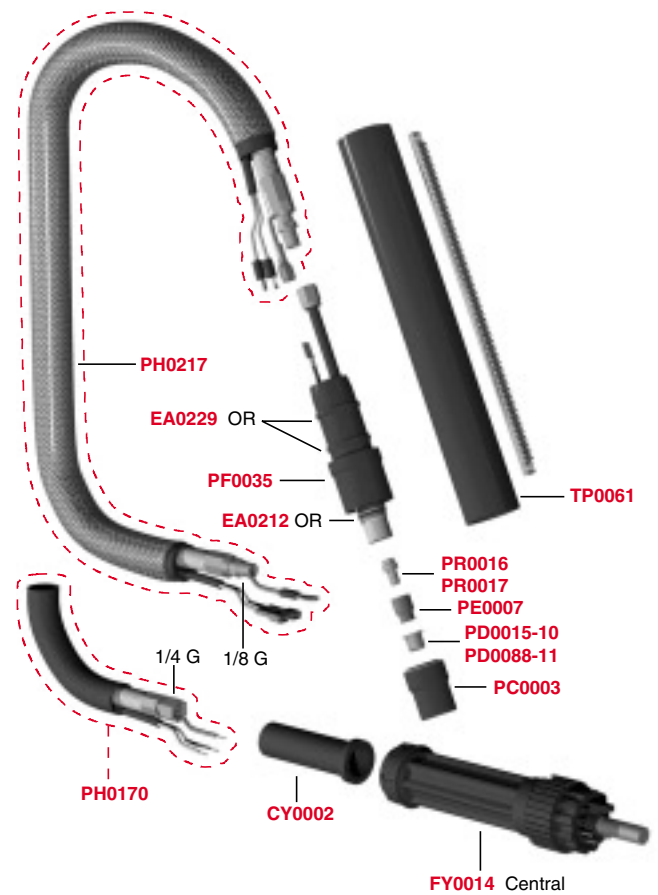

COMPLETE TORCH

Pt. No.	Description	Pack	Euro	D
PA1280	Plasma CB 50 P machine torch 6m	1	260,00	B
PA1281	Plasma CB 50 P machine torch 6m central adaptor	1	285,00	B

TECHNICAL DATA

Voltage class	M
Standard lenght m	6
Air consumption	165 l/min
Air pressure	5 bar
Duty cycle 60%	50 A
Duty cycle 100%	40 A

