

# PLASMA HY 40

PLASMA RANGE

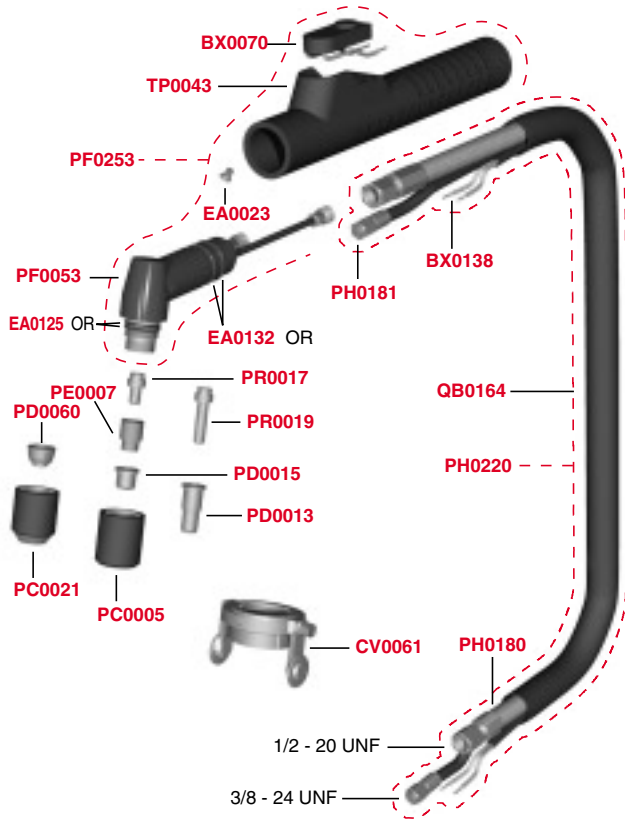

*trafimet*



Pt. No.	Description	Pack	Euro	D
BX0070	Microswitch	10	9,50	B
BX0138	Control cable per meter		6,50	B
CV0060	Circle cutting attachment	1	55,00	B
CV0061	Carriage	1	21,00	B
CV0085	Flowmeter S 75 / HY 40	1	4,50	A
EA0023	Screw	50	0,05	B
EA0125	O-ring	10	0,55	A
EA0132	O-ring	10	0,55	A
PC0005	Outside nozzle (020104)	4	8,00	A
PC0021	Outside nozzle (020200)	4	7,20	A
PD0013	Long tip (020466 - 1370)	10	1,20	A
PD0015	Tip (020115 - 1304)	10	0,80	A
PD0060	Tapered tip (020197)	10	1,85	A
PE0007	Air diffuser	2	7,50	A
PF0053	Torch head HY 40	1	104,00	A
PF0253	Torch head HY 40 with handle	1	130,00	A
PH0180	Air-power cable 6m	1	58,00	B
PH0181	Pilot-arc cable 6m HY 40	1	37,00	B
PH0220	Cable assembly 6m	1	155,00	B
PR0017	Electrode - Hf. (020103 / 1521-H)	10	1,05	A
PR0019	Long electrode - Hf. (020647)	10	1,60	A
QB0164	Outer protection liner A 141 per meter		4,20	B
TP0043	Handle black Ø 24,5	1	13,00	B

## COMPLETE TORCH

Pt. No.	Description	Pack	Euro	D
PA0430	Plasma MAX 40 torch 6m	1	270,00	B

## TECHNICAL DATA

Voltage class **M**

Standard length **6 m**

Air consumption **127 l/min**

Air pressure **4.1 bar**

Duty cycle 60% **40 A**

Duty cycle 100% **30 A**

