

PLASMA HY 100

PLASMA RANGE



IEC 60974-7

trafimet[®]

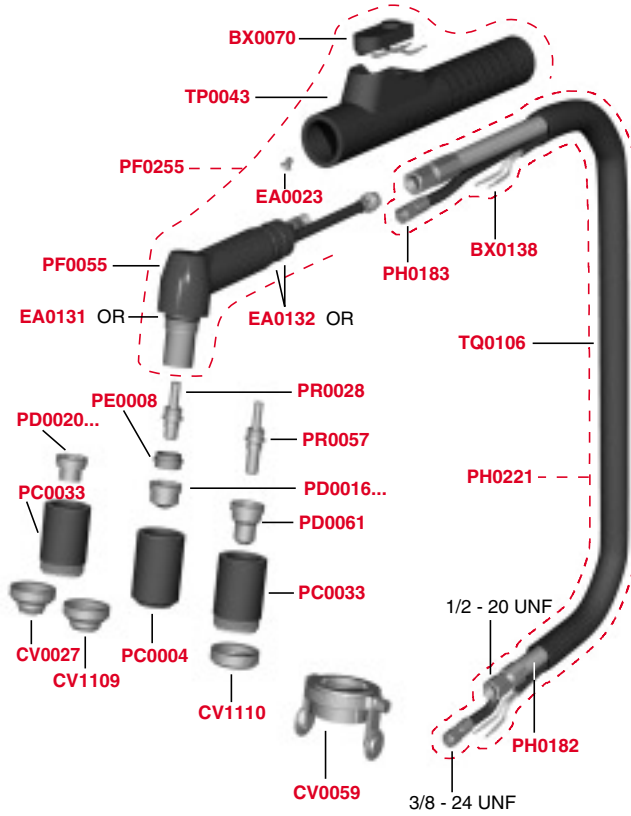

Pt. No.	Description	Pack	Euro	D
BX0070	Microswitch	10	9,50	B
BX0138	Control cable per meter		6,50	B
CV0027	Contact cutting attachment	10	7,80	A
CV0058	Circle cutting attachment HY 100	1	52,00	B
CV0059	Carriage HY 100	1	22,00	B
CV0094	Flowmeter CB 150 / HY 100	1	4,50	A
CV1109	Contact cutting attachment (020334)	10	9,00	B
CV1110	Contact cutting attachment (020333)	10	9,00	B
EA0023	Screw	50	0,05	B
EA0131	O-ring	10	0,50	A
EA0132	O-ring	10	0,55	A
PC0004	Outside Nozzle (020184)	2	15,00	A
PC0033	Contact cutting nozzle long life	2	28,00	A
PD0016-10	Tip Ø 1,0 - 40A - .038 (020203)	10	1,40	A
PD0016-13	Tip Ø 1,3 - 80A - .052 (020345)	10	1,40	A
PD0016-15	Tip Ø 1,5 - 100A - .059 (020195)	10	1,40	A
PD0020-13	Tip Ø 1,3 - 80A - .052 (020397)	10	1,40	A
PD0020-15	Tip Ø 1,5 - 100A - .059 (020337)	10	1,40	A
PD0061	Long tip (020563)	10	3,10	A
PE0008	Air diffuser (020194)	2	8,50	A
PF0055	Torch head HY 100	1	135,00	A
PF0255	Torch head HY 100 with handle	1	160,00	A
PH0182	Air-power cable 6m	1	50,00	B
PH0183	Pilot-arc cable 6m HY 100	1	37,00	B
PH0221	Cable assembly 6m	1	200,00	B
PR0028	Electrode - Hf. (020191)	10	1,70	A
PR0057	Long electrode - Hf. (020564)	10	3,80	A
TP0043	Handle black Ø 24,5	1	13,00	B
TQ0106	Outer cover 20x22 per m		1,60	B

COMPLETE TORCH

Pt. No.	Description	Pack	Euro	D
PA0450	Plasma MAX 80 / 100 torch 6m	1	340,00	B

TECHNICAL DATA

Voltage class	M
Standard length m	6
Air consumption	200 l/min
Air pressure	4.5 bar
Duty cycle 60%	100 A
Duty cycle 100%	80 A

