

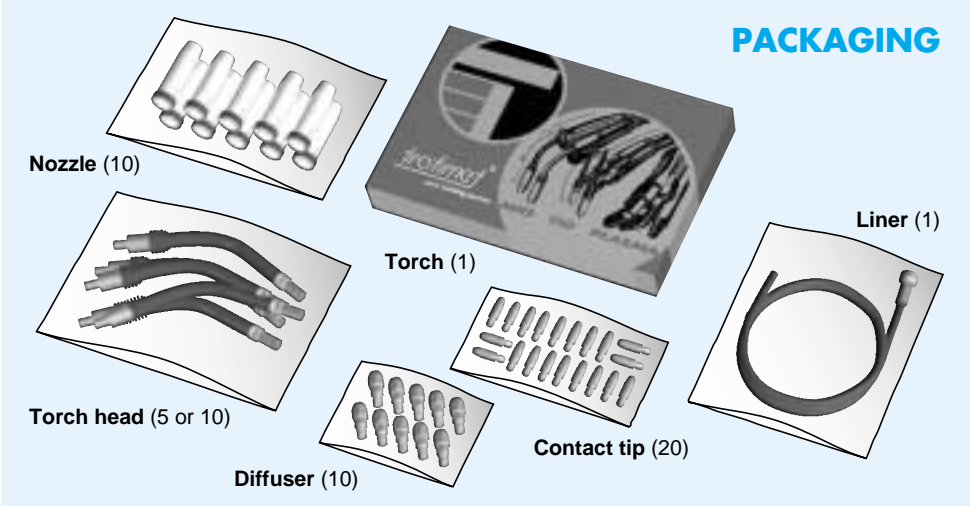

PACKAGING



Nozzle (10)

Torch (1)

Liner (1)

Torch head (5 or 10)

Diffuser (10)

Contact tip (20)

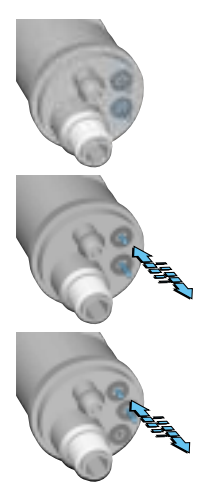

	ERGOPLUS 15	m	Liner	Adaptor	Trigger
EURO FIXED PINS	MA 7003	3	GM 500	AR 60	BX 24
	MA 7004	4	GM 501	AR 60	BX 24
	MA 7005	5	GM 502	AR 60	BX 24
EURO SPRING PINS	MA 7043	3	GM 500	AR 54	BX 24
	MA 7044	4	GM 501	AR 54	BX 24
	MA 7045	5	GM 502	AR 54	BX 24
EURO-SAF SPRING PINS 3 CONTACTS	MA 7063	3	GM 500	AR 5	BX 68
	MA 7064	4	GM 501	AR 5	BX 68
	MA 7065	5	GM 502	AR 5	BX 68

Ergonomical handle with new design
Impugnatura ergonomica con nuovo design
Ergonomische Griffschale in neuem Design
Poignée ergonomique avec nouveau dessein

Spherical joint
Giunto sferico
Kugelgelenk
Joint sphérique

Protection cable spring
Molla di protezione cavo
Knickschutzfeder
Ressort de protection câble

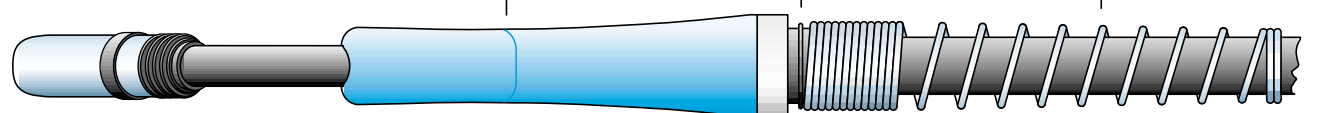

ERGOPLUS

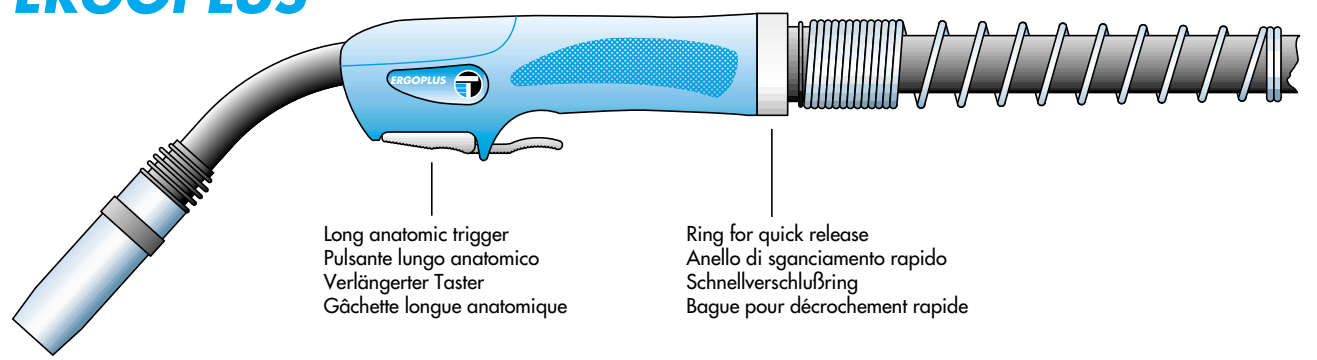

Long anatomic trigger
Pulsante lungo anatomico
Verlängerter Taster
Gâchette longue anatomique

Ring for quick release
Anello di sganciamento rapido
Schnellverschlussring
Bague pour décrochement rapide



trafimet[®]
your welding partner

TRAFIMET spa claim that all items on this catalogue are manufactured in conformity with the "low voltage" CE 73/23 directive as per EN 60974-7 standard. The company reserve the right to modify any products without notice. TRAFIMET spa is the registered owner of all trademarks, patents and models.

Copyright © 1997 Trafimet Spa. All rights reserved. Print date 06/00 EA 0500

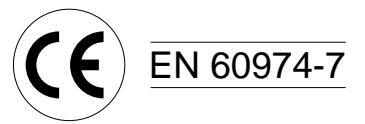

ERGOPLUS 15

MIG TORCHES

trafimet[®]

your welding partner

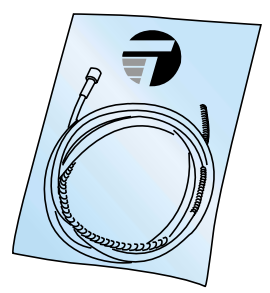
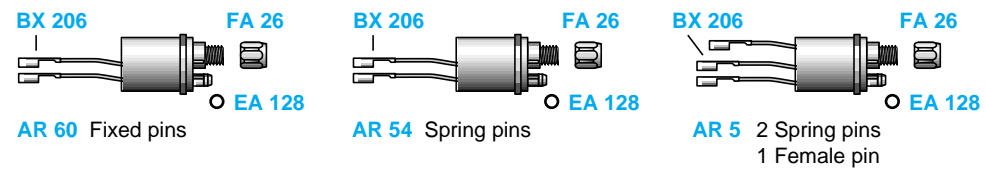
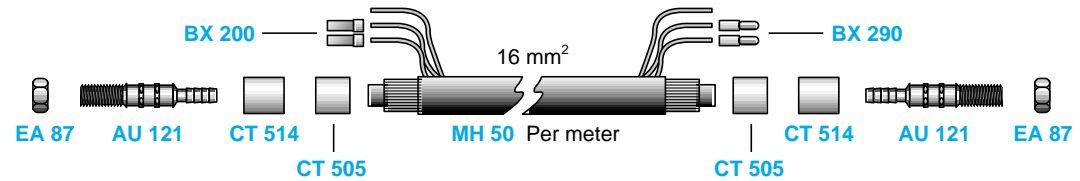
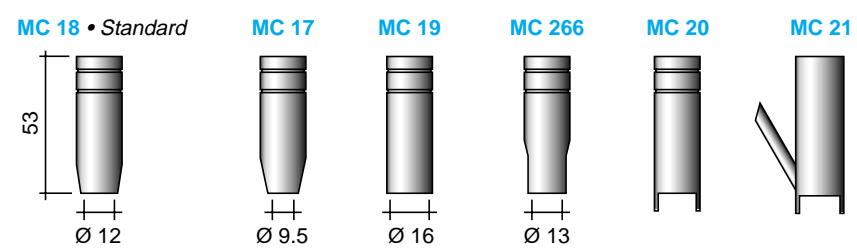
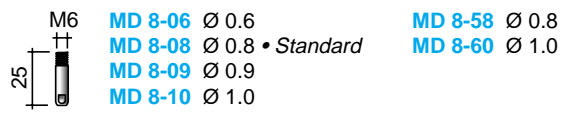
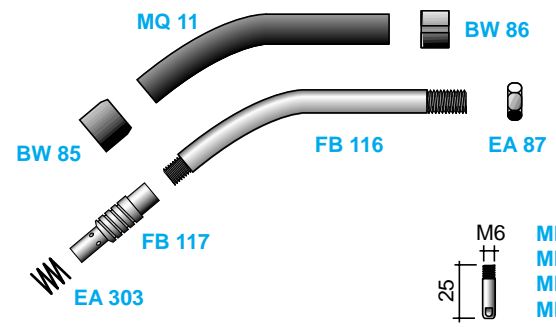
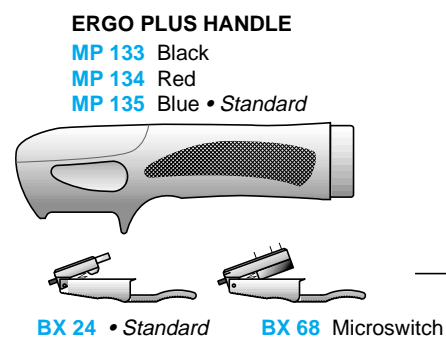
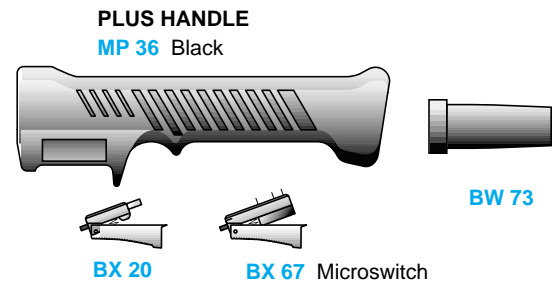
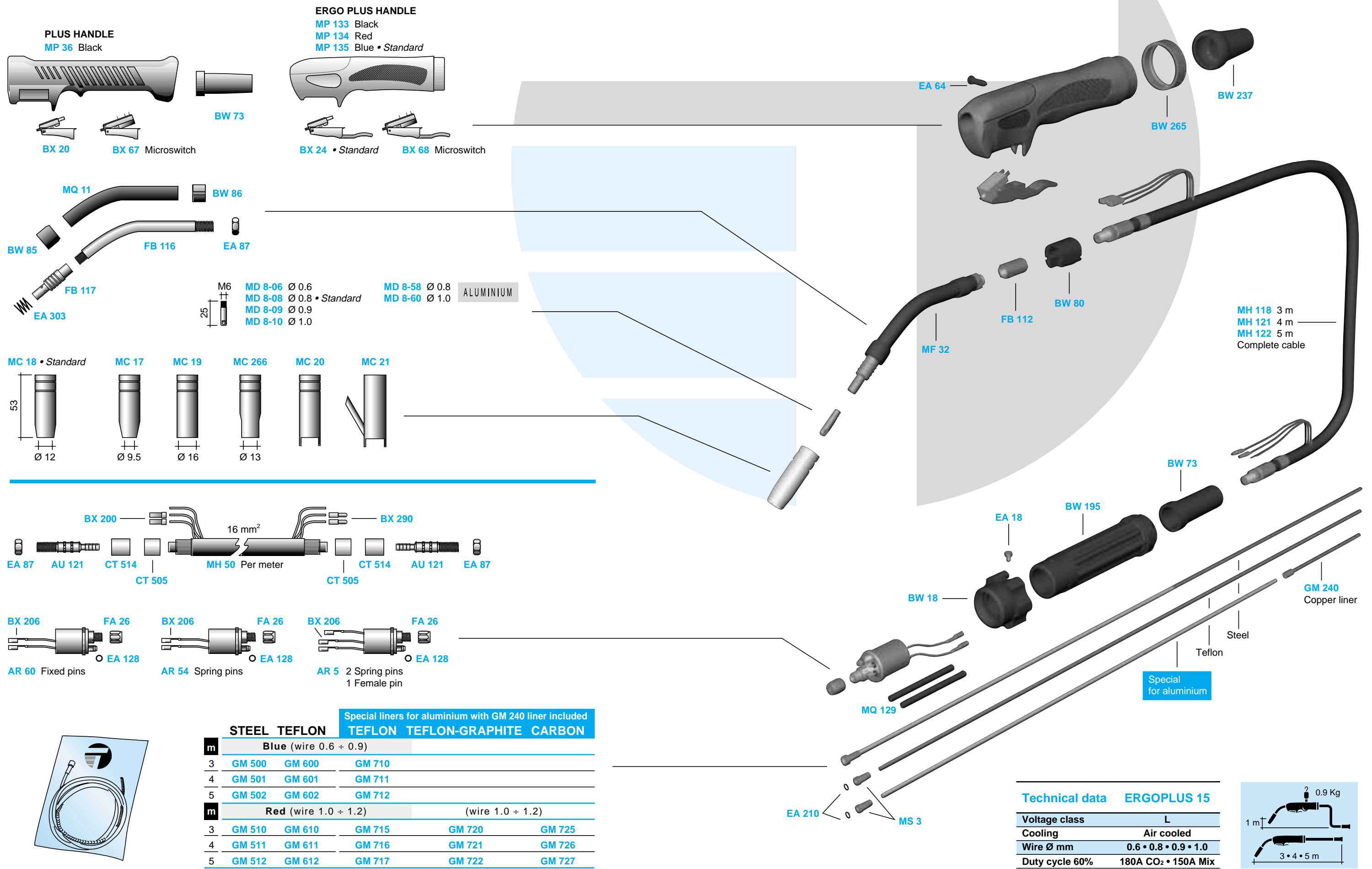

	Blue (wire 0.6 ÷ 0.9)	TEFLON	TEFLON-GRAPHITE	CARBON	
m					
3	GM 500	GM 600	GM 710		
4	GM 501	GM 601	GM 711		
5	GM 502	GM 602	GM 712		
				(wire 1.0 ÷ 1.2)	
m					
3	GM 510	GM 610	GM 715	GM 720	GM 725
4	GM 511	GM 611	GM 716	GM 721	GM 726
5	GM 512	GM 612	GM 717	GM 722	GM 727

Technical data ERGOPLUS 15

Voltage class	L
Cooling	Air cooled
Wire Ø mm	0.6 • 0.8 • 0.9 • 1.0
Duty cycle 60%	180A CO ₂ • 150A Mix

